

Inner West Council Libraries Historical Site Study

Djarrawunang Ward



“When the British arrived in January 1788, there were more than 1500 Aboriginal people living in the area from Botany Bay to Broken Bay and as far west as Parramatta”



**Djarrawunang – Magpie
(Ashfield Ward)**



Inner West Council

Local Government Area Ward Boundaries





“Macquarie set about making the Liverpool-road in 1812, and gradually, bit by bit, small communities developed at intervals along its circuitous route. ... The country between the Liverpool-road and Cook's River was thickly wooded, an outstanding feature being gigantic trees.”

The Sun, Saturday 17 January 1931, page 7

“Our first day's journey was merely an afternoon drive to Parramatta, fifteen miles from Sydney, through alternate cleared land and "bush", but all enclosed. ... The system of "clearing" here, by the total destruction of every native tree and shrub, gives a most bare, raw, and ugly appearance to a new place – unless a settler can see an expanse of bare, naked, unvaried, shadeless, dry, dusty land spread all around him, he fancies his dwelling "wild and uncivilised".

Louisa Meredith’s 1840s, description of the Parramatta Road





INNER WEST

**Canterbury House, ca 1860, Conrad Martens, Mitchell
Library, State Library of New South Wales**

“... there were no houses along the railway line until Ashfield was reached, nor were there any elsewhere in the vicinity except on Parramatta-road. ... I remember that where Summer Hill stands was all open paddocks for many years ... From Summer Hill site to Canterbury was all paddocks and bush, without houses. Ashfield on the south of the line along Liverpool-road, contained a few scattered houses ...The north side of the railway between the station and Parramatta-road was without houses ...”

Recollections of Mr. C. A. Henderson in 1923 of the first passenger train in 1855





Left, Ashfield Station ca. 1900 Right, Ashfield Station 2017

Ashfield was one of only four stops on the Central to Parramatta passenger train route when it opened September 26 1855



LOOKING SOUTH TOWARDS ASHFIELD SHOPPING CENTRE FROM ASHFIELD
RAILWAY STATION.

PHOTO BY
Harry M. Hen



State Library of NSW

**Sir Henry Parkes lived in
Milton House in the 1870s**

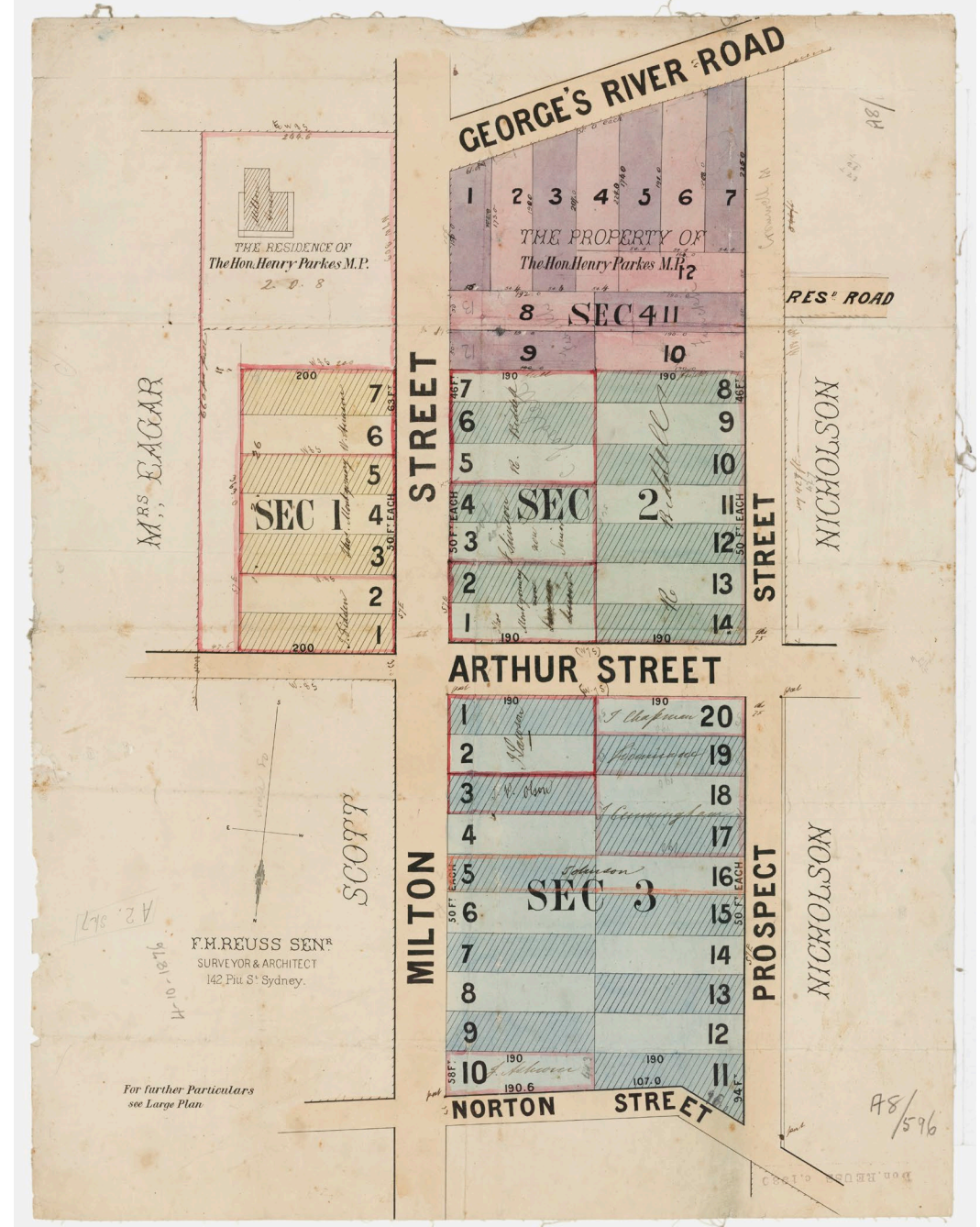

Z/SP/A8/596, State Library of NSW_FL10461546



Wedding party of Elsie Chong and Frank Lau photographed in front of Milton House, 1923



Chinese population (from Bagnall 2011 page 65)

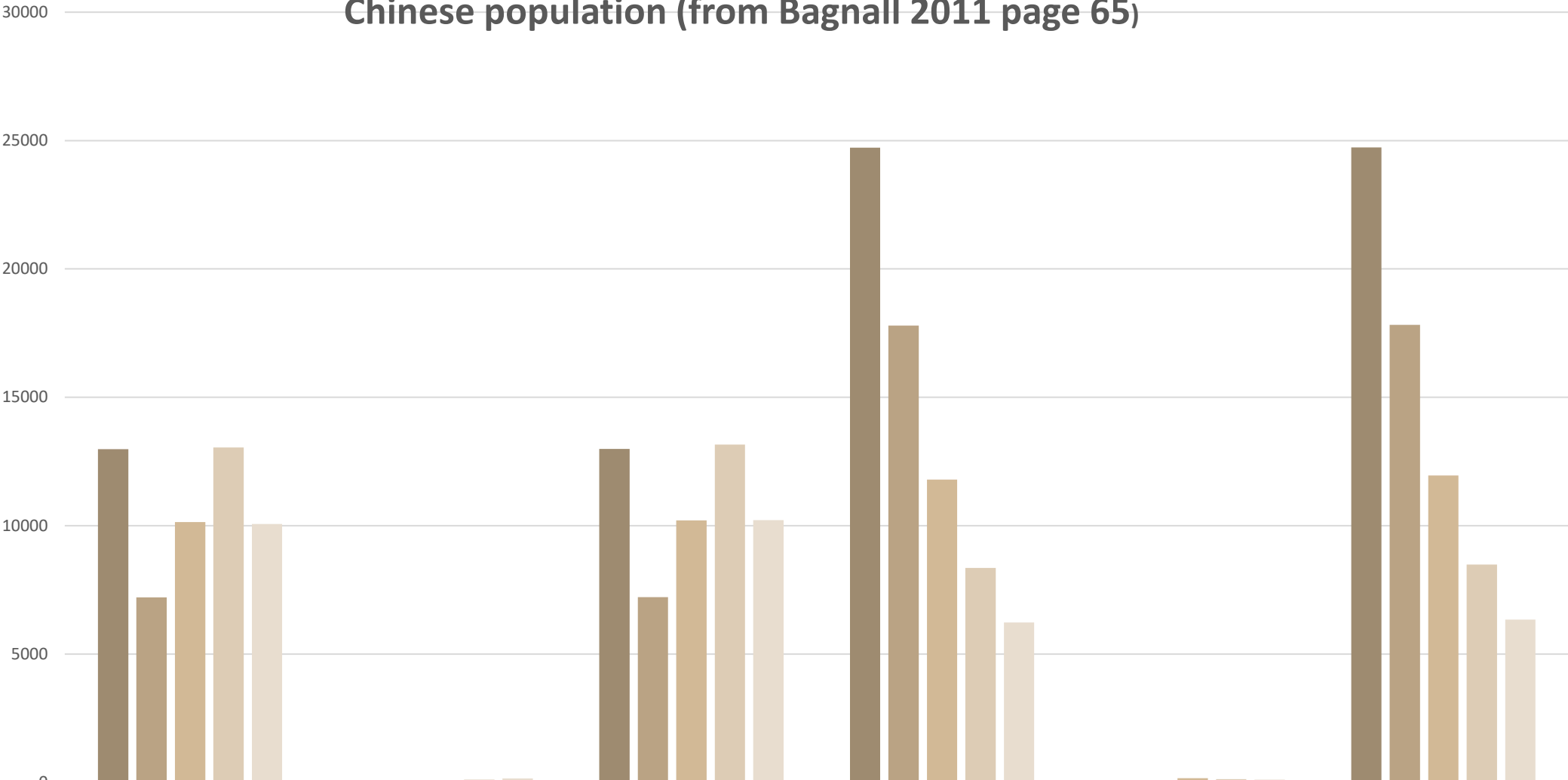

	Male NSW	Female NSW	Total NSW	Male VIC	Female VIC	Total VIC
1861	12986	2	12988	24724	8	24732
1871	7208	12	7220	17795	31	17826
1881	10141	64	10205	11795	164	11959
1891	13048	109	13157	8355	134	8489
1901	10063	159	10222	6236	111	6347

1861 1871 1881 1891 1901

1861 NSW *Chinese Immigration Regulation and Restriction Act*

The Influx of Chinese Restriction Act 1881 applied an entrance tax of £10 [today = \$1,523) ... This Act was amended in 1887, raising the poll tax to £100 [today = \$18,190]

The *Federal Immigration Restriction Act* became law in 1901. This Act specified how exclusion would be accomplished by the dictation test. It was designed to exclude all non-Europeans. This lay behind what became known as the “White Australia Policy.





“The Elite Hall”— not only the elite hall, but the hall of the elite. Members of the Government, members of Parliament, M.L.C, consuls, ministers of all religions, and parsons of every degree; doctors and lawyers, and litterateurs and art, City Fathers, distinguished strangers from the four corners of the earth, ...”

Evening News, Thursday 8 December 1898, p 7



Gallop House, Ashfield

QUONG TART AND CO.,
WHOLESALE AND RETAIL
TEA MERCHANTS,
AND
IMPORTERS OF EASTERN MERCHANDISE.

Office and Sample Room :
28, SYDNEY ARCADE (over George-street Entrance).

Tea Tasting and Refreshment Rooms :
NO. 29, KING-STREET (Ground Floor); NO. 44, 46, 48,
AND 50 UPSTAIRS (King-street Entrance).

ROYAL ARCADE:
TEA ROOMS, NO. 7 AND 42.

Importers of High-class Teas only.



Powerhouse Collection, Gift of Mrs Agnes Glass 1991,
Photo Jean-Francois Lanzarone

“Sydney Arcade ... opened in 1881 ... the famous luncheon rooms of Quong Tart and Co. Here a cup of splendid tea, accompanied by some palatable edible, may be obtained at all hours...”

1947 CENSUS ASHFIELD DWELLINGS DATA

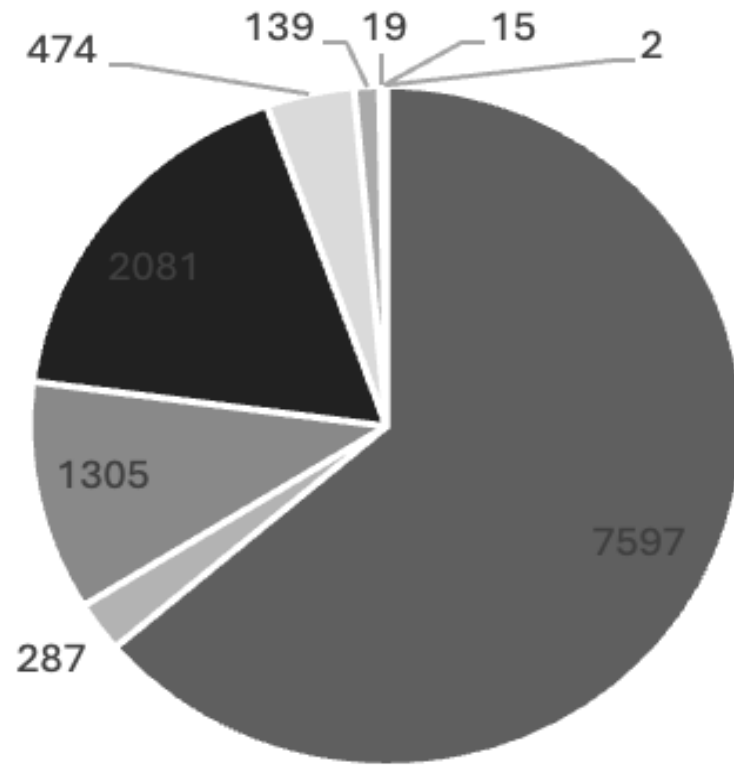

- Private house (one family)
- Private house (shared by > 2 families)
- Share of private house
- Flat, inc. share of flat
- Tenement
- Hotel, boarding or lodging house
- Educational, religious or charitable institutions
- Other
- Wagon and camp



Wong Tai Zin & Kwan Yin Kur Temple, Liverpool Road, Summer Hill