

- GENERAL NOTES:**
- REFER TO STRUCTURAL ENGINEER'S DRAWINGS FOR DETAILS OF FOOTINGS, SLABS, STAIR AND RAMP DETAILS, AND ALL OTHER STRUCTURAL DETAILS.
  - REFER TO CIVIL ENGINEER'S DRAWINGS AND LANDSCAPE DRAWINGS, FOR ROADWORKS, FINISHES, SETOUTS AND ROAD DETAILS, PAVED AREAS AND FINISHED EXTERNAL LEVELS.
  - REFER TO LANDSCAPE ARCHITECT'S DRAWINGS FOR ALL LANDSCAPE WORKS, SETOUT OF FOOTPATHS, PAVED AREAS, FINISHED PAVING LEVELS AND TREES.
  - REFER TO CIVIL ENGINEER'S DRAWINGS AND LANDSCAPE ARCHITECT DRAWINGS FOR DETAILS AND SURFACE FINISH OF BITUMEN AND CONCRETE PAVED ROADWORKS.
  - REFER TO LANDSCAPE ARCHITECT'S DRAWINGS AND SPECIFICATION FOR DETAILS OF PROTECTION TO EXISTING TREES TO BE RETAINED.
  - REFER TO HYDRAULIC ENGINEER'S DRAWINGS AND SPECIFICATION FOR ALL HYDRAULIC DETAILS.
  - REFER TO CIVIL AND HYDRAULIC ENGINEER'S DRAWINGS FOR ALL STORMWATER AND DRAINAGE DETAILS.
  - REFER TO ELECTRICAL ENGINEER'S DRAWINGS AND SPECIFICATION FOR ALL DETAILS OF EXTERNAL LIGHTING AND POWER.
- EXISTING WALLS  
 AREAS NOT PART OF PHASE 2 WORKS
- NOTE: TONED AREA NOT INCLUDED IN VARIATION WORKS

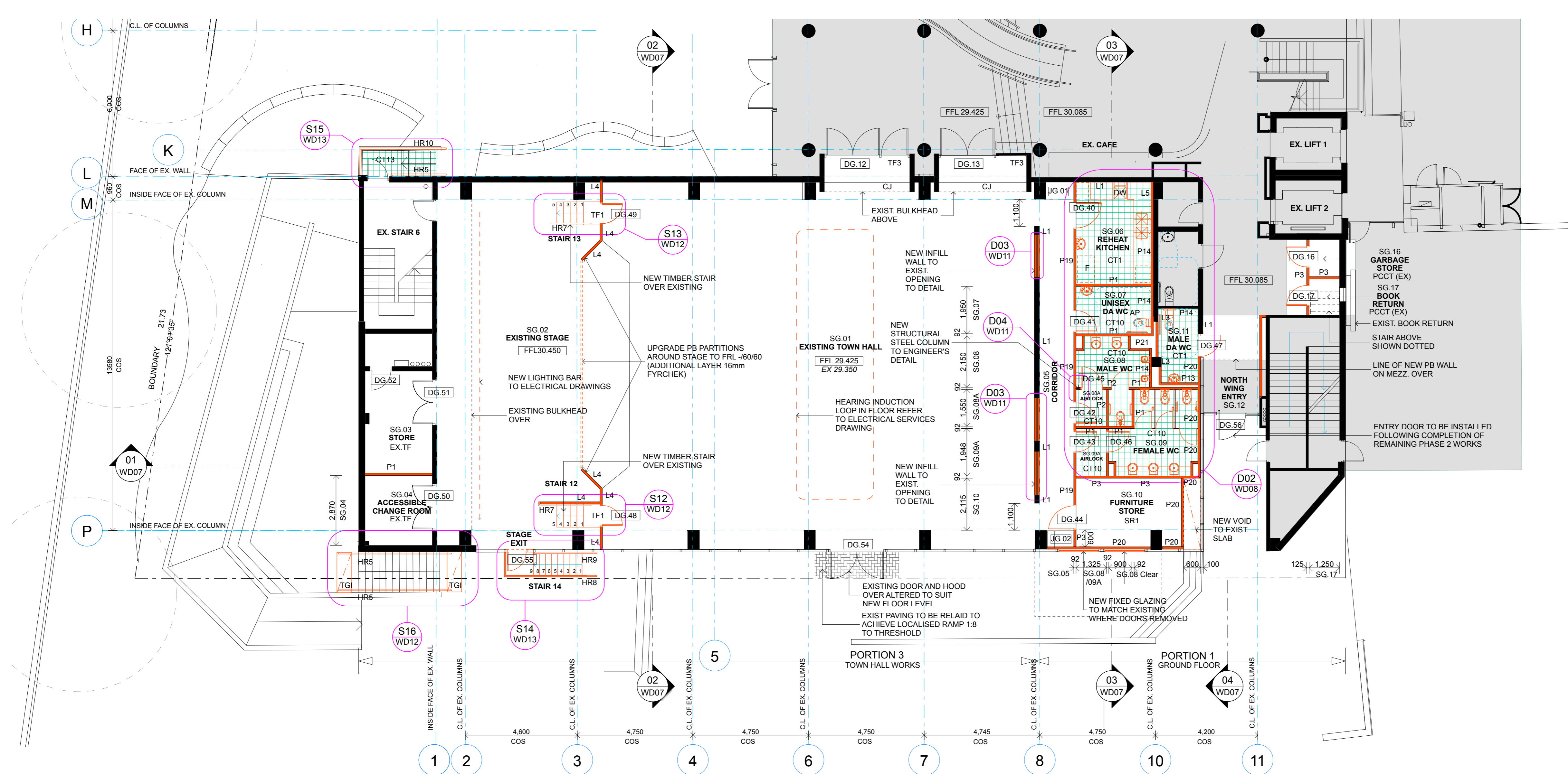

A	Issued for Construction	17/07/12
Nº	Revision	Date



**Ashfield Council**  
Ashfield Civic Centre  
Phase 2 - Stage 3



**Rapid CONSTRUCTION**

Rapid Construction Pty Ltd | ABN 35 003 983 620  
407 Church Street North Parramatta NSW 2153  
PO Box 2250 North Parramatta NSW 1750  
Phone 02 9683 9000 Facsimile 02 9683 9099 Web www.rapidgroup.net.au  
Email Project@rapidconstruction.com.au

**McDivitt Group Architects**

McDivitt Group Architects Pty Ltd  
1301, 54 Miller Street North Sydney NSW 2060  
T: 02 99675392 F: 02 99675374  
E: mg@mgc.com.au W: www.mcdvittgroup.com.au

NSW Architects Registration Board No. 4207  
ABN No. 13 020 029 811

**Ground & Mezzanine Construction Plan**

THE PROPERTY IN THIS DRAWING AND IN THE CONCEPT'S BRIEFING WITH MCDIVITT GROUP ARCHITECTS, ANY UNAUTHORIZED USE OF THIS DRAWING, AS TO THE WHOLE OR PART MAY RENDER THE USER LIABLE TO AN ACTION FOR DAMAGES. CONSEQUENTIAL EVENTS OR DAMAGES ARISING FROM UNAUTHORIZED OR UNLAWFUL USE SHALL NOT BE THE LIABILITY OF MCDIVITT GROUP ARCHITECTS OR THEIR ASSOCIATED COMPANIES LIABLE.

Date:	June 2012	Project No:	12 852	AMEND
Scale:	1:100@A1	Drawing No:	WD05	<b>A</b>