

**LEGEND-CIVIL & LANDSCAPE WORKS**

- PROPOSED RELAYING NEW ASPHALT FOOTPATH SURFACE
- PROPOSED FOR ROAD RE-SHEETING
- PROPOSED RECONSTRUCTION OF EXISTING DRIVEWAY
- TWO EXISTING CONCRETE DRIVEWAYS TO REMAIN
- NEW CONCRETE DISH DRAIN
- NEW CONCRETE KERB ONLY
- NEW CONCRETE KERB & GUTTER
- PROPOSED NEW CONCRETE KERB RAMP
- EXISTING KERB RAMP TO REMAIN
- EXISTING TREE, TO REMAIN, DO NOT DISTURB THE EXISTING ROOT SYSTEM

**EXISTING PARKING-NO PARKING LOSS**

**REPLACE EXISTING LINTEL AND GRATE**

**EXISTING LINTEL AND GRATE TO REMAIN**

**EXISTING ROAD SIGNS, TO REMAIN-SEE NOTES**

**EXISTING ROAD SIGNS, TO REMOVE-SEE NOTES**

**NEW ROAD SIGNS, TO REINSTALL**

**EXISTING SEWER PIT, TO REMAIN**

**EXISTING STORM WATER PIT-TYPE 1, TO REMAIN**

**EXISTING STORM WATER PIT-TYPE 2, TO REMAIN**

**EXISTING PAVERS WALKWAY, TO REMAIN**

**EXISTING POWER POLE AND LIGHT**

**CHECKED & APPROVED**

**SURVEYED & DRAFTED**

**DESIGNED**

**APPROVED FOR CONSTRUCTION**

**DOCUMENT REFERENCE**

**SERVICES AFFECTED**

**SERVICES**

**DATE**

**DATUM**

**SCALES (ORIGINAL A1)**

**1:100**

**INNER WEST COUNCIL**

**STEPHEN STREET, BALMAIN (AT VINCENT ST)**

**PROPOSED KERB INDENTATION**

**CONSULTATION PLAN-SHOWN ROADWORKS**

**PROJECT NO.**

**301987**

**PLAN NO.**

**10203**

**CAD FILE**

**301987-10203-01.DWG**

**SHEET NO.**

**1/2**

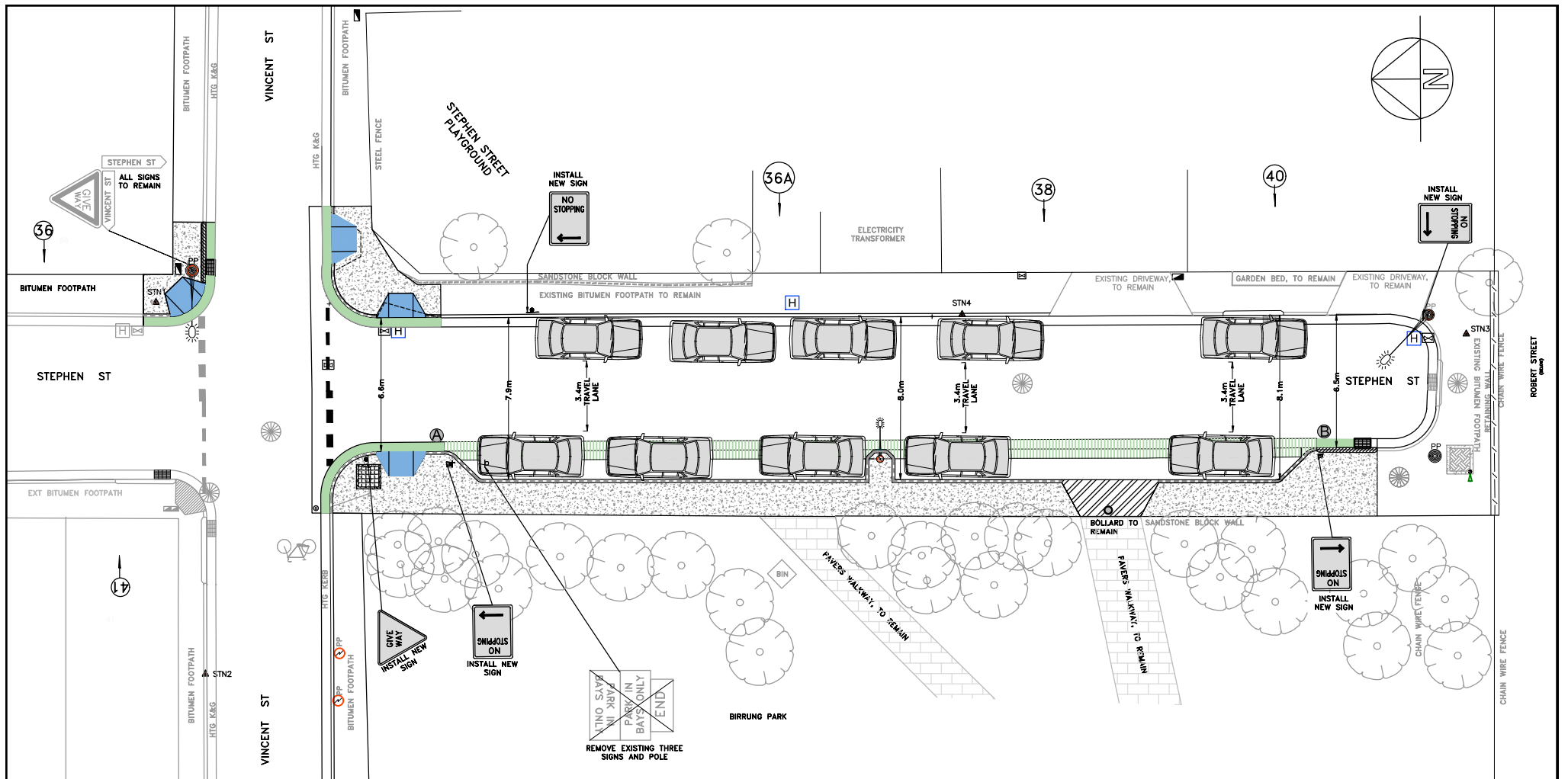

LEGEND—CIVIL & LANDSCAPE WORKS		EXISTING PARKING—NO PARKING LOSS		EXISTING ROAD SIGNS, TO RELOCATE—SEE NOTES		EXISTING POWER POLE AND LIGHT	
	PROPOSED RELAYING NEW ASPHALT FOOTPATH		NEW CONCRETE DISH DRAIN		NO STOPPING		EXISTING SEWER PIT, TO REMAIN
	PROPOSED FOR NEW ROAD RE-SHEETING		NEW CONCRETE KERB ONLY		REPLACE EXISTING LINTEL AND GRATE		EXISTING STORM WATER PIT—TYPE 1, TO REMAIN
	PROPOSED RECONSTRUCTION OF EXISTING DRIVEWAY		NEW CONCRETE KERB & GUTTER		EXISTING LINTEL AND GRATE TO REMAIN		EXISTING STORM WATER PIT—TYPE 2, TO REMAIN
	TWO EXISTING CONCRETE DRIVEWAYS TO REMAIN		RECONSTRUCT CONCRETE KERB RAMP		EXISTING ROAD SIGNS, TO REMAIN—SEE NOTES		EXISTING PAVERS WALKWAY, TO REMAIN
	AVAILABLE TEN (10) CARS' PARKING SPOTS—NO LOSS OF PARKING FOR THE PROPOSED CONSTRUCTION		EXISTING KERB RAMP TO REMAIN		EXISTING ROAD SIGNS, TO RELOCATE—SEE NOTES		EXISTING POWER POLE AND LIGHT
	EXISTING TREE, TO REMAIN, DO NOT DISTURB THE EXISTING ROOT SYSTEM		REMOVE EXISTING THREE SIGNS AND POLE		NEW T81 LINE		
			REMOVE EXISTING THREE SIGNS AND POLE		NEW T82 LINE		
					HOUSE NUMBER		

CHECKED & APPROVED	SURVEYED & DRAFTED AD MAR 2022		DOCUMENT REFERENCE	R.M.S.	SERVICES	DATUM	<b>INNER WEST COUNCIL</b> <b>STEPHEN STREET, BALMAIN (AT VINCENT ST)</b> <b>PROPOSED KERB INDENTATION</b> <b>CONSULTATION PLAN—SHOWN PARKING</b>		PROJECT NO. 301987	SHEET NO. 2/2
DESIGNED MH APR 2022	APPROVED FOR CONSTRUCTION MH APR 2022		SERVICES AFFECTED	CONRA (GAS) / SHELL PIPELINES	TELSTRA / OPTUS	A. H. D.			PLAN NO. 10203	
DRAWN MH APR 2022				SYDNEY WATER	WATER	SCALES (ORIGINAL A1) 1:100			CAD FILE 301987-10203-01.dwg	