

29 August 2024

## Upcoming Traffic Works – Centennial Street, Marrickville

Dear Residents,

Inner West Council is investing \$53,000 to improve drainage on Centennial Street, Marrickville (primarily in front of No. 9 to No. 11A) to better manage stormwater in the area and upgrade the aging stormwater infrastructure.

The works include:

- Construction of 3 new kerb inlet pits.
- Installation of 6.5m length of new concrete stormwater pipe.
- Reconstruct 80sqm concrete footpath.
- Reconstruct 18m concrete kerb & gutter.
- Reconstruct 16sqm of existing Tree Pit.

The General Arrangement plan is available on Council's website at <https://www.innerwest.nsw.gov.au/develop/council-run-works-and-projects/park-building-and-streetscape-projects>

### Timing of work

The works will commence the week of 30 September 2024 and take approximately two weeks to complete (weather permitting).

### Reducing construction impacts

Traffic control will be employed to manage traffic and pedestrian flow around the site. Access to properties will be maintained; however, please note that some car parking spaces near the works will be closed to the public during construction. Please avoid parking next to or near the active work zones.

### Enquiries

Council's contractor: Civotek P/L  
Ibrahim Hawat, 0416 661 160

Council officer: Nick Poulos, Project Manager, 02 9392 5526  
nick.poulos@innerwest.nsw.gov.au

We appreciate your patience and co-operation while we complete this important work.

Yours faithfully,

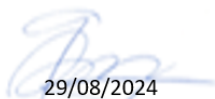

29/08/2024

**Predrag Gudelj | Coordinator Roads and Stormwater Projects**  
**Inner West Council**

















**FOOTPATH NOTES 4:**

1. **ASPHALT**
  - A) ALL AC TO RMS QA SPECIFICATIONS R116, AS 2734 INCLUDING TABLE 3.3 AND AS 2758.5, BUT ANY REQUIREMENTS/SPECIFICS ON THIS PLAN TAKE PRIORITY.
  - B) BITUMEN CLASS: 320
  - C) MAY USE RAP IN MIX - 10% BY VOLUME.
2. **KERB RAMPS**
  - A) SEE STANDARD PLAN F4.
3. **ROAD BASE**
  - A) COMPACTION: 95% STANDARD.
  - B) RECYCLED DGB SPECIFICATION: FOR SUPPLY OF RECYCLED MATERIAL FOR PAVEMENTS, EARTHWORKS, AND DRAINAGE REFER TO SPECIFICATION FOR SUPPLY OF RECYCLED MATERIAL FOR PAVEMENTS, EARTHWORKS AND DRAINAGE' BY IPWEA (NSW) (LATEST EDITION).
4. **EXCAVATION**
  - A) AT ALL JOINTS TO EXISTING CONCRETE/ASPHALT - THE JOINT SHALL BE SAW CUT BEFORE EXCAVATION.
  - B) ALL EXCAVATED MATERIAL SHALL BE REMOVED FROM THE SITE AND DISPOSED OF AT A LICENSED WASTE DISPOSAL FACILITY.
5. **UTILITIES, SERVICES & SURVEY MARKS**
  - A) ALL UNDERGROUND UTILITY SERVICES SHALL BE CHECKED FOR LEVEL AND LOCATION PRIOR TO COMMENCEMENT OF WORKS, BY THE CONTRACTOR.
  - B) ALL SERVICE COVERS AFFECTED BY THE WORKS SHALL BE ADJUSTED AS REQUIRED AND TO SUIT THE LEVELS OF THE NEW WORK. NO SERVICE FITTINGS SHALL BE COVERED.
  - C) PROPERTY STORMWATER PIPES: WHERE AFFECTED, SHALL BE REPLACED WITH 90MM UPVC OR TO SUIT EXISTING AND INVERT SHALL MATCH THE GUTTER LEVEL.
  - D) STATE SURVEY MARKS (SSM'S) - SHALL NOT BE DISTURBED UNLESS APPROVED BY ETH COUNCIL ENGINEER.
6. **NATURE STRIP RESTORATION**
  - A) MATCH EXISTING TURF.
  - B) IF NEW TURF IS SPECIFIED - USE SOFT LEAF BUFFALO "SHADEMASTER", LAID ON 100MM THICK PREPARED TOPSOIL, AS SPECIFIED BY THE COUNCIL ENGINEER.
7. **EXISTING SIGNAGE**
  - A) SUCH SIGNAGE SHALL BE REINSTATED UNLESS THE COUNCIL ENGINEER ADVISES OTHERWISE.
  - B) HERITAGE STREET NAME SIGNS EMBEDDED IN FOOTPATH PAVING AND KERBS - CAUTION SHALL BE EXERCISED TO NOT DAMAGE THESE SIGNS AND THE CONTRACTOR SHALL LIAISE WITH THE COUNCIL ENGINEER TO DETERMINE WHAT ACTION TO IMPLEMENT WHERE DISTURBANCE OF THE SIGN IS ESSENTIAL.
8. **RESIDENT NOTIFICATION**
  - A) ALL RESIDENTS AFFECTED BY THE WORKS SHALL BE NOTIFIED AT LEAST 2 WORKING DAYS BEFORE THE RELEVANT WORK COMMENCES AND ANY REASONABLE REQUESTS ACCOMMODATED.
9. **SAFETY/SIGNAGE/ACCESS**
  - A) DURING CONSTRUCTION, ADEQUATE WARNING SIGNS AND BARRICADING SHALL BE PROVIDED TO ENSURE THAT THE WORK SITE MEETS THE REQUIREMENTS OF AS 1742.2 & 1743.3, AND TO PROVIDE ADEQUATE PROTECTION TO PEDESTRIANS & MOTORISTS.
  - B) ADEQUATE AND SAFE ACCESS FOR PEDESTRIANS SHALL BE PROVIDED AT ALL TIMES.
  - C) AT DRIVEWAYS - PREVENTION OF ACCESS SHALL BE KEPT TO AN ABSOLUTE MINIMUM AND ARRANGEMENTS SHALL BE MADE WITH THE RESIDENT/BUSINESS, BY THE CONTRACTOR, FOR A SUITABLE DAY/TIME FOR THIS WORK. USE OF HIGHER STRENGTH CONCRETE, WITH SHORTER CURING TIME MAY BE NECESSARY.
10. **DIMENSIONS**
  - A) ALL DIMENSIONS ARE IN MILLIMETRES UNLESS SHOWN OTHERWISE.
11. **GENERAL**
  - B) ALL WORKS SHALL BE CARRIED OUT TO COUNCIL'S SPECIFICATION, TO BEST PRACTICE STANDARDS, AND TO THE SATISFACTION OF COUNCIL'S SUPERVISING ENGINEER.
  - C) DURING AND AFTER EXCAVATION, ANY UNSOUND AREAS BELOW THE CONCRETE WORK SHALL BE DRAWN TO THE COUNCIL ENGINEER'S ATTENTION, TO ESTABLISH IF ANY ADDITIONAL EXCAVATION/ BASE COURSE IS NECESSARY.
  - D) THE WORK SITE SHALL BE KEPT IN A CLEAN, TIDY, AND SAFE CONDITION AT ALL TIMES AND TO THE SATISFACTION OF COUNCIL'S ENGINEER.
12. **DOCUMENT PRIORITY**
  - A) THIS PLAN SUPERSEDES ANY STATEMENTS ON OTHER DOCUMENTS, EG SPECIFICATIONS, OTHER PLANS, ETC. UNLESS ADVISED BY THE COUNCIL ENGINEER.
13. **INSPECTIONS**

INSPECTIONS BY THE COUNCIL SUPERVISING ENGINEER SHALL BE REQUIRED AT THE FOLLOWING STAGES AND AS OTHERWISE DIRECTED BY THE COUNCIL ENGINEER:

  - A) EXCAVATION COMPLETED.
  - B) ROAD BASE PLACED AND COMPACTED.
  - C) ASPHALTIC CONCRETE PLACE & COMPACTED.
  - D) COMPLETED.
14. **DESIGN & SETTING OUT**
  - A) SETTING OUT SHALL BE THE RESPONSIBILITY OF THE CONTRACTOR EXCEPT WHERE A SURVEYED ALIGNMENT OR DETAILED LEVELS ARE PROVIDED BY THE COUNCIL, IN WHICH CASE THE COUNCIL SHALL BE RESPONSIBLE TO PROVIDE THE REQUIRED DETAILS TO THE CONTRACTOR, IE DISTANCES IN ALL DIMENSIONS FROM FIXED POINTS.  
THE CONTRACTOR MAY NEED TO SAVE THESE 'FIXED POINTS' DURING EXCAVATION, BY TRANSFERRING THEM ELSEWHERE USING A MEASURING TAPE AND SPIRIT/LASER LEVEL.  
IT IS THE CONTRACTOR'S RESPONSIBILITY TO ACHIEVE THE DESIGN ALIGNMENT AND LEVEL AS PER THE COUNCIL PROVIDED DETAILS.
  - B) WHERE NO DESIGN LEVELS ARE ISSUED (MOST CASES), THE CONTRACTOR SHALL AIM TO HAVE THE COMPLETED WORK ATTAIN A REASONABLY SMOOTH LONGITUDINAL PROFILE, AND FOR FOOTPATH WORKS A REASONABLY UNIFORM FOOTPATH CROSSFALL OF 2% (MAXIMUM 4%), UNLESS DIRECTED OTHERWISE BY THE COUNCIL SUPERVISOR.  
DUE COGNIZANCE SHALL BE GIVEN TO THE EXISTING PROPERTY LEVELS, PARTICULARLY PATHS AND FLOORS - THIS OFTEN LEADS TO A VARYING OF THE CROSSFALL AND/OR LEVEL OF THE NEW KERB/GUTTER/FOOTPATH.  
WHEN THE SITE CREATES DIFFICULTY IN ACHIEVING THE ABOVE, THE CONTRACTOR SHALL LIAISE WITH THE SUPERINTENDENT AND WORK TOGETHER, CO-OPERATIVELY, TO ACHIEVE A REASONABLE OUTCOME.

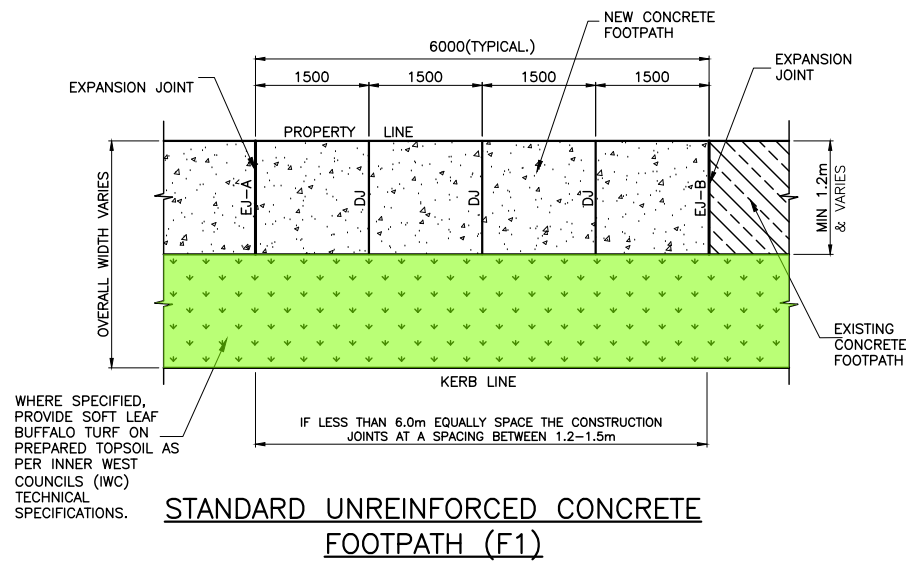

**STANDARD UNREINFORCED CONCRETE FOOTPATH (F1)**

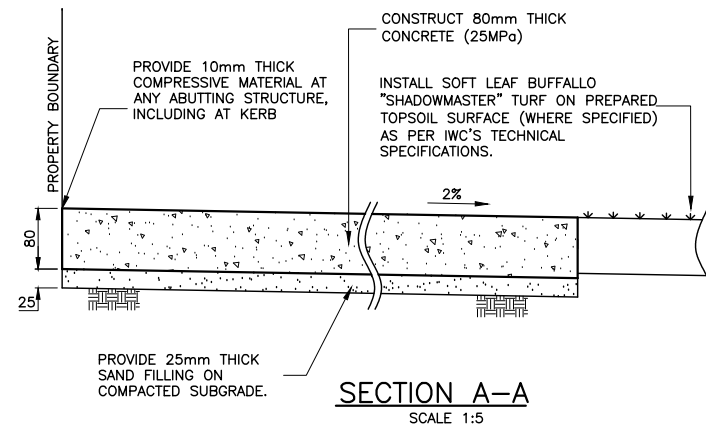

**SECTION A-A**  
SCALE 1:5

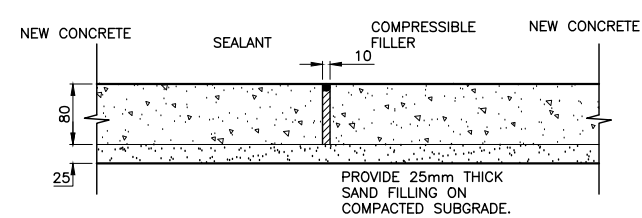

**EXPANSION JOINT A (EJ-A)**  
SCALE 1:5

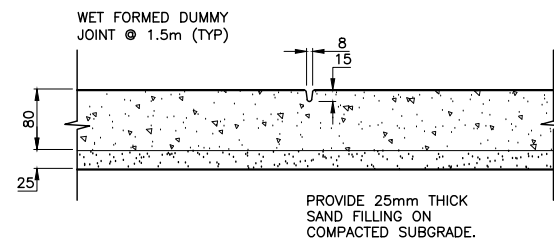

**DUMMY JOINT (DJ)**  
SCALE 1:5

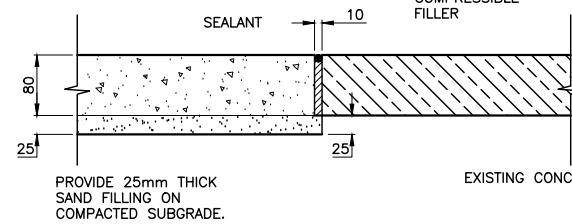

**EXPANSION JOINT B (EJ-B)**  
SCALE 1:5

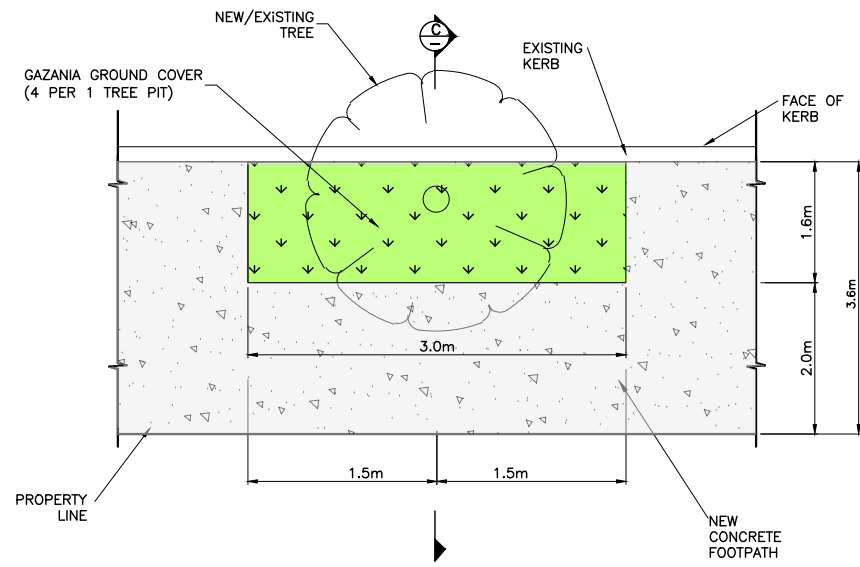

**TREE PIT DETAILS**  
NEW/EXISTING TREE IN TREE-PIT & GROUND COVER  
SCALE 1:50

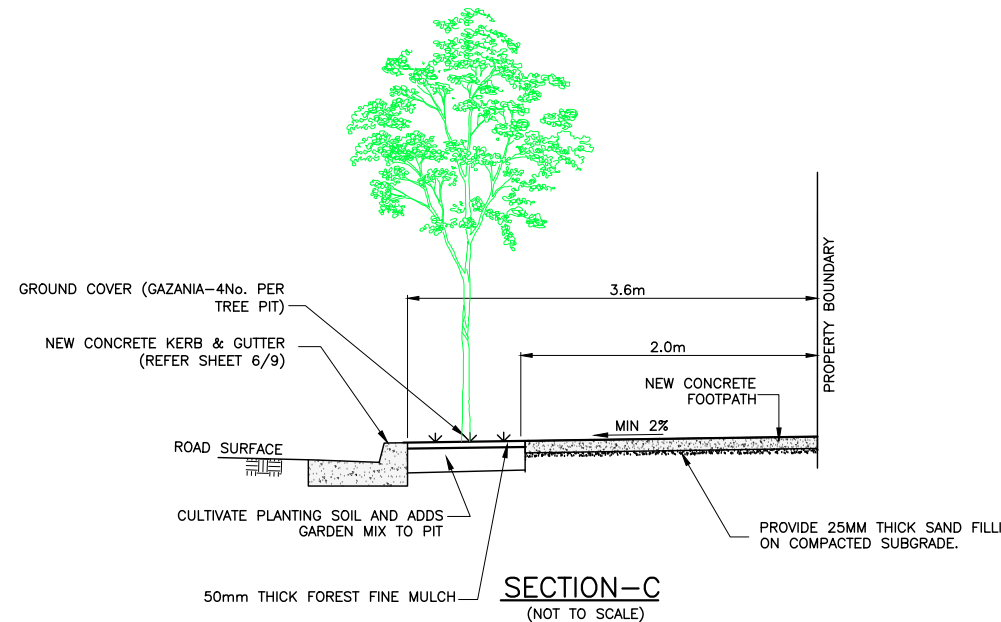

**SECTION-C**  
(NOT TO SCALE)

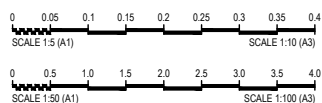

NOTE:  
WHERE NEW TREES ARE INSTALLED - PROVIDE TREE ROOT BARRIER SURE GRO TYPE RB600H OR SIMILAR APPROVED TO MANUFACTURERS SPECIFICATION.

**ISSUE FOR CONSTRUCTION**

CHECKED & APPROVED 	SURVEYED BY ADAM DILLON 22-11-2022			SURV. GEN. R.M.S.	COORDINATE SYSTEM GDA2020	CENTENNIAL STREET, MARRICKVILLE NEAR NO.9 & NO.11 CENTENNIAL STREET PROPOSED STORMWATER UPGRADE TYPICAL DETAILS 03	PROJECT NO. 303025	SHEET NO. 8 of 9
	DESIGNED BY SANJOY 12-07-2023			TELSTRA / OPTUS AUSGRID NOTICE OF ENTRY KERB & GUTTER	SCALES (ORIGINAL A1) AS SHOWN		PLAN NO. 10233	SHEET REV #
APPROVED FOR CONSTRUCTION 	DRAWN BY SANJOY 14-07-2023	2-14 FISHER STREET, PETERSHAM NSW 2049 Ph. 02 9392 5000 Post: PO Box 14 PETERSHAM council@innerwest.nsw.gov.au Web: https://www.innerwest.nsw.gov.au	NOTICES DATE	REV. DATE DESCRIPTION APPROV.				

# UTILITIES LEGEND

EXISTING SERVICES	
DRAINAGE LINE	
ELECTRICITY	
GAS	
OIL PIPELINE	
SEWER	
TELECOM	
WATER SUPPLY	
OPTIC FIBER	
SUBSOIL	
NBN	
OPTUS	
OVERHEAD ELECT.	
O'HD ELECT & TEL	
UNKNOWN	

**! WARNING !**  
**BEWARE OF UNDERGROUND SERVICES**  
 THE LOCATION OF UNDERGROUND SERVICES HAVE BEEN INTERPOLATED FROM AERIAL PHOTOGRAMMETRIC DATA OR KNOWN POSITIONS OF VALVES, MANHOLES ETC. OR INFORMATION SUPPLIED BY SERVICE AUTHORITIES. NO RESPONSIBILITY IS TAKEN FOR THE ACCURACY OF THE INTERPOLATED INFORMATION SUPPLIED. ENSURE ALL SERVICES ARE ACCURATELY LOCATED PRIOR TO COMMENCEMENT OF WORK.

**IMPORTANT**  
 IN CASE OF EMERGENCY, CONTACT THE FOLLOWING UTILITIES IF THEIR SERVICES ARE INVOLVED:

TELSTRA	:	132203
JEMENA (GAS)	:	131909
SYDNEY WATER	:	132090
AUSGRID	:	131388

**NOTE**  
 CONTRACTOR TO REINSTATE ALL KERB & GUTTER, ROAD PAVEMENT AND FOOTPATHS AFFECTED BY WORKS TO INNER WEST COUNCIL STANDARD AND TO THE SATISFACTION OF THE MANAGER, CAPITAL PROGRAM.

**NOTE**  
 CONTRACTOR TO LOCATE ALL HOUSE SERVICES (GAS, WATER) PRIOR TO CONSTRUCTION. SERVICES TO BE ADJUSTED AS REQUIRED.

**NOTE**  
 WATER, SEWER, TELSTRA, GAS & ELECTRICITY SERVICES IN VICINITY OF WORKS. CONTRACTOR TO CONTACT SYDNEY WATER, TELSTRA, JEMENA & AUSGRID PRIOR TO EXCAVATION.



UTILITIES, IF SHOWN, ARE DIAGRAMMATIC ONLY. CONTRACTORS ARE RESPONSIBLE TO LOCATE AND AVOID DAMAGE TO THEM AS SPECIFIED BY EACH UTILITIES EXCAVATION GUIDELINES.

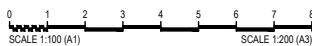
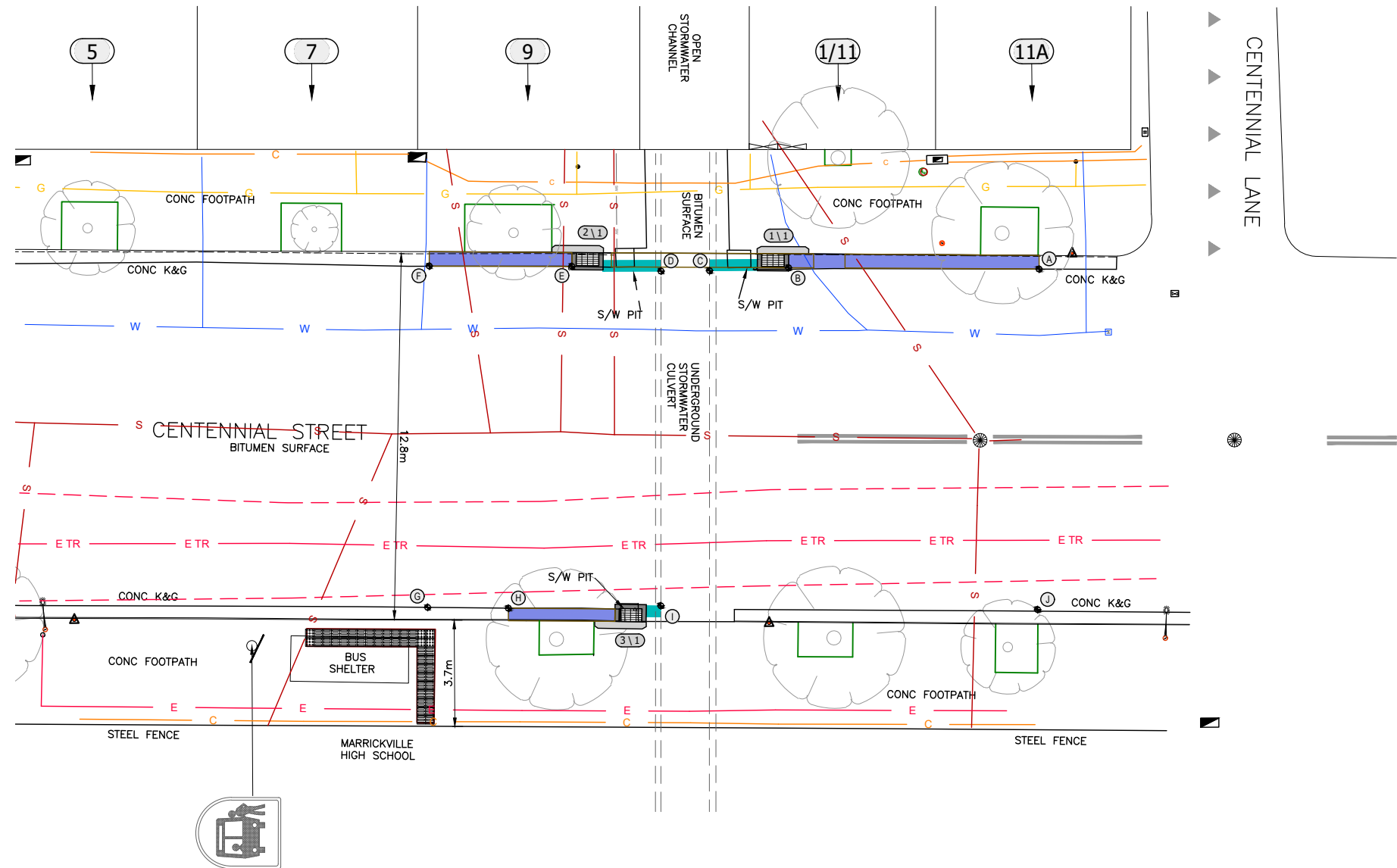

\\wcc-flo02\innerwest.nsw.gov.au\assets and Environment\EST\LCR\24\512\SU\303025-MAR-11\CentennialSt-Pit&gullyupgrade(102333).L1.DESIGN\12. FinalDesign(1002)Docx\303025-10233-Plan.dwg

CHECKED & APPROVED  APPROVED FOR CONSTRUCTION 	SURVEYED BY ADAM DILLON 22-11-2022	<b>INNER WEST</b> 2-14 FISHER STREET, PETERSHAM NSW 2049 Ph. 02 9392 5000 Post: PO Box 14 PETERSHAM council@innerwest.nsw.gov.au Web: https://www.innerwest.nsw.gov.au		SURV. GEN. R.M.S. A.G.L. / SHELL PIPELINES SYDNEY WATER TELSTRA / OPTUS AUSGRID NOTICE OF ENTRY KERB & GUTTER NOTICES DATE	COORDINATE SYSTEM GDA2020	CENTENNIAL STREET, MARRICKVILLE NEAR NO.9 & NO.11 CENTENNIAL STREET PROPOSED STORMWATER UPGRADE UTILITIES	PROJECT NO. 303025	SHEET NO. 9 of 9
	DESIGNED BY SANJOY 12-07-2023			SCALES (ORIGINAL A1) 1:100	PLAN NO. 10233		SHEET REV #	