

# INNER WEST

## INNER WEST COUNCIL WEST STREET, PETERSHAM AT THE BOULEVARDE

### PROPOSED RAISED PEDESTRIAN CROSSING

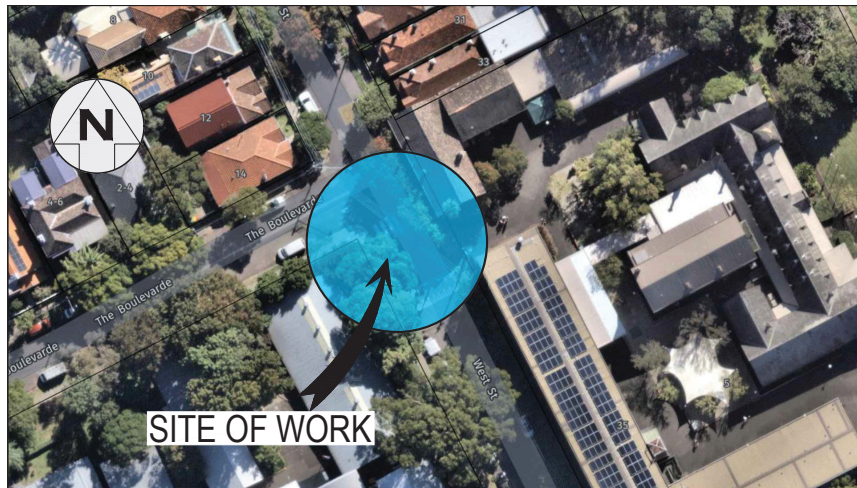

LOCALITY SKETCH  
N.T.S.

IMAGE COURTESY OF NEARMAP

**PROJECT #: 303082**  
**PLAN #: 10241**

**FOR  
CONSTRUCTION**

UNLESS DETAILED ON THIS DRAWING  
ALL WORK SHALL CONFORM TO



UTILITIES, IF SHOWN, ARE  
DIAGRAMMATIC ONLY. CONTRACTORS  
ARE RESPONSIBLE TO LOCATE AND  
AVOID DAMAGE TO THEM AS  
SPECIFIED BY EACH UTILITIES  
EXCAVATION GUIDELINES.

#### DRAWING SCHEDULE

SHEET #	SHEET TITLE
1	COVER SHEET
2	NOTES & SCHEDULES
3	DEMOLITION
4	GENERAL LAYOUT – FOOTPATH, KERB, GUTTER & CROSSING
5	GENERAL LAYOUT – SIGNS, LINEMARKING & ROADWAY
6	GENERAL LAYOUT – KERB BLISTER & PLANT ARRANGEMENTS
7	LONG SECTION CHAINAGES – LAYOUT PLAN
8	LONG SECTION DETAILS – ALIGNMENT INV1, INV2 & INV3
9	CROSS SECTION DETAILS – ALIGNMENT INV1
10	CROSS SECTION DETAILS – ALIGNMENT INV1
11	CROSS SECTION DETAILS – ALIGNMENT INV2
12	CROSS SECTION DETAILS – ALIGNMENT INV2
13	CROSS SECTION DETAILS – ALIGNMENT INV3
14	KERB BLISTER ISLANDS
15	RAISED PEDESTRIAN CROSSING DETAILS
16	CONCRETE FOOTPATH (F1) AND (F2) DETAILS
17	CONCRETE KERB, GUTTER, KERB RAMP & SIGNS DETAILS
18	UNDERGROUND UTILITIES

CHECKED & APPROVED  20/11/23	SURVEYED BY ADAM DILLON 06-02-23		DOCUMENT REFERENCE	SURV. GEN. R.M.S. A.G.L. / SHELL PIPELINES SYDNEY WATER TELSTRA / OPTUS AUSGRID	COORDINATE SYSTEM ASSUMED SCALES (ORIGINAL A1) N.A.	PROJECT NO. 303082	SHEET NO. 1 of 18

\\ms-002\innerwest.nsw.gov.au\wengj\wengj\Projects\303082-PE- WestSt@TheBoulevard-RiseWMC\10241-PAWP\_V\DESIGN\12\_Final\Design\10241-Plans.dwg

## GENERAL NOTES

- DURING CONSTRUCTION THE WORK IS TO BE SIGNPOSTED AND MARKED TO THE REQUIREMENTS OF AS1742.2-2009 AND AS1742.3-2009 "TRAFFIC CONTROL DEVICES FOR WORKS ON ROADS".
- ALL WORK IS TO BE CARRIED OUT IN ACCORDANCE WITH COUNCIL'S TECHNICAL SPECIFICATION (AUS-SPEC) AND TO BEST PRACTICE STANDARDS AND TO THE SATISFACTION OF COUNCIL'S MANAGER, CAPITAL PROGRAM.
- OVERLAY TO CONSIST OF 40mm THICK AC10. REFER TO RELEVANT SECTION FOR DETAILS.
- ALL RESIDENTS AFFECTED BY THE PROPOSED WORKS SHOULD BE NOTIFIED AT LEAST 3 WORKING DAYS BEFORE THE COMMENCEMENT OF ROADWORKS.
- EXISTING SURFACE FITTINGS OF THE SERVICES SHALL BE ADJUSTED AS NECESSARY TO THE REQUIREMENTS OF THE RELEVANT AUTHORITY.
- SUITABLE VEHICULAR ACCESS SHALL BE MAINTAINED TO EACH LOT OR ALTERNATIVE ARRANGEMENTS MADE WITH THE OWNERS.
- WORK ONLY TO BE CARRIED OUT BETWEEN THE HOURS OF 7am AND 5pm FROM MONDAY TO SATURDAY. NO WORK PERMITTED ON SUNDAYS.
- ALL SERVICES TO BE CHECKED FOR LEVEL AND LOCATION PRIOR TO COMMENCEMENT OF WORK.
- ALL SERVICES AFFECTED BY NEW WORK TO BE ADJUSTED AS REQUIRED TO SUIT. NO SERVICE SURFACE FITTINGS ARE TO BE COVERED.
- PROJECT MANAGER TO INSPECT FOR ALL UNSOUND AREAS BEFORE PROFILING AC PAVEMENT AND AFTER PROFILING. WEAK SECTIONS ARE TO BE IDENTIFIED AND HEAVY-PATCHED TO A NOMINAL THICKNESS OF 150mm WITH AC28 BEFORE RESEALING IN ACCORDANCE TO TYPICAL CROSS-SECTION.
- THE LOCATION OF UNDERGROUND SERVICES AND HOUSE CONNECTIONS HAVE NOT BEEN SHOWN ON THIS PLAN AND MUST BE VERIFIED ON-SITE BY THE CONTRACTOR WITH REPRESENTATIVES FROM EACH OF THE UTILITY AUTHORITIES. CONTACT DIAL BEFORE YOU DIG PH: 1100
- EXISTING SIGNS TO REMAIN UNLESS OTHERWISE NOTED.
- ALL LINEMARKING AND RRPMS REMOVED OR AFFECTED DURING THE COURSE OF THE WORKS IS TO BE REINSTATE UNLESS NOTED OTHERWISE. ALL LINEMARKING IS TO COMPLY WITH RMS SPECIFICATION R141 - "PAVEMENT MARKING" AND TO BE THERMOPLASTIC TYPE AND INCLUDE PLASTIC BEADS IN ACCORDANCE WITH RMS SPECIFICATIONS 3357 AND 3353 RESPECTIVELY. ALL RRPMS TO COMPLY WITH RMS SPECIFICATION R142. ALL ROAD COLOURED PAINT MARKINGS TO COMPLY WITH RMS SPECIFICATION R110
- AREAS OF HEAVY PATCHING ARE TO BE MARKED OUT ON SITE PRIOR TO COMMENCEMENT OF WORK BY PROJECT MANAGER AND CIVIL DESIGN ENGINEER. REFER TO NOTE 10.
- THE CONTRACTOR SHALL ENSURE THAT ALL EXISTING SURROUNDING AREAS NOT REQUIRED TO BE REPLACED OR RESET AS PART OF THE WORKS SHALL NOT BE DAMAGED DURING THE COURSE OF THE WORKS.
- ASPHALTIC CONCRETE SHALL CONFORM TO RMS SPECIFICATIONS R116 - "ASPHALT (DENSE GRADED AND OPEN GRADED)".
- INSPECTIONS ARE TO TAKE PLACE AT THE FOLLOWING STAGES AND AS OTHERWISE DIRECTED BY THE MANAGER, CAPITAL PROGRAM.  
**ROAD PAVEMENT**  
A. SUBGRADE TRIMMED AND CONSOLIDATED PRIOR TO FIRST PAVEMENT. (NOTE: SINGLE AXLE TRUCK WITH 81 LOAD TO BE AVAILABLE FOR PAVEMENT TEST).  
B. EACH PAVEMENT LAYER SPREAD AND COMPACTED. (NOTE: SINGLE AXLE TRUCK WITH 81 LOAD TO BE AVAILABLE FOR PAVEMENT TEST.)  
C. PAVEMENT COMPLETED PRIOR TO SEALING CONCRETE WORKS  
(i) EXCAVATION COMPLETED  
(ii) FORMWORK AND REINFORCEMENT SET  
(iii) CONCRETE FORMED AND CURED  
18. LINEMARKING AND SIGNPOSTING ARE TO BE INSTALLED AS SOON AS PRACTICABLE.  
19. KERB FACES OF ALL ISLANDS TO BE PAINTED WHITE AND TO INCLUDE GLASS BEADS IN ACCORDANCE WITH RMS SPECIFICATION NO. 3353.  
20. KERB RAMPS TO BE PROVIDED WHERE SHOWN TO INNER WEST COUNCIL STANDARD BY MAINTAINING WITH MAXIMUM GRADIENT 1 IN 8.  
21. USE CAUTION TO PRESERVE HERITAGE LISTED STREET NAME PLAQUES EMBEDDED IN FOOTPATH WHEN CONSTRUCTION FOOTPATHS AND KERB RAMPS (IF SHOWN). NO STATE SURVEY MARKS ARE TO BE REMOVED PRIOR TO CONSULTING WITH COUNCIL'S SURVEY SERVICE.  
22. INSTALL "CHANGED TRAFFIC CONDITIONS AHEAD" SIGNS ON ALL APPROACHES 75-100m IN ADVANCE OF THE INTERSECTION AND MAINTAIN FOR 3 MONTHS.  
23. ALL TRAFFIC SIGNS TO COMPLY WITH RMS GA SPECIFICATION R143 AND TO BE OF HIGH INTENSITY CLASS 1.  
24. ALL PATHWAYS WHERE AFFECTED BY CONSTRUCTION WORKS SHALL BE RECONSTRUCTED TO COUNCIL'S STANDARD SPECIFICATION.  
25. EXISTING LINEMARKING IS TO BE REMOVED BY GRINDING WORKS WHERE NEW LINEMARKING IS REQUIRED OR PAVED.  
26. ALL SIGNPOSTING ON SPLITTER, KERB OR PEDESTRIAN REFUGE ISLANDS TO BE ERECTED USING V-NOTCH INSERTS EMBEDDED INTO CONCRETE (OR SIMILAR AS APPROVED BY COUNCIL).  
27. ALL CONCRETE ELEMENTS TO BE OF 25MPa UNLESS OTHERWISE STATED.

## EROSION AND SEDIMENT CONTROL

### 1. GENERAL MEASURES

- STOCKPILES SHALL BE CONFINED TO ONE CENTRAL AREA WHERE POSSIBLE.
- EROSION CONTROL MEASURES TO BE IN PLACE PRIOR TO COMMENCEMENT OF ANY CONSTRUCTION WORK. MEASURES ARE APPLIED TO PROTECT ADJOINING PROPERTIES FROM EROSION AND SILT DAMAGE.
- EROSION CONTROL MEASURES NOT TO BE REMOVED UNTIL CONSTRUCTION IS COMPLETED AND SITE HAS BEEN REHABILITATED.
- REHABILITATION INCLUDES COMPLETION OF ALL CONSTRUCTION WORK AND LANDSCAPING, SEEDING OR TURFING OF ALL BATTERS AND FILL AREAS.
- PIPED DRAINAGE NETWORKS SHOULD BE INSTALLED AND CONNECTED AS EARLY AS POSSIBLE.
- ALL AREAS NOT SUBJECT TO CONSTRUCTION WORKS SHALL BE RETAINED FREE FROM DISTURBANCE OR DAMAGE DURING THE CURRENCY OF THE CONTRACT. SHOULD THESE AREAS BECOME DISTURBED OR DAMAGED, THEY SHALL BE RE-INSTATED BY THE CONTRACTOR AT NO COST TO THE PRINCIPAL.
- ALL AREAS NOT SUBJECT TO CONSTRUCTION WORKS SHALL BE RETAINED FREE FROM DISTURBANCE OR DAMAGE DURING THE CURRENCY OF THE CONTRACT. SHOULD THESE AREAS BECOME DISTURBED OR DAMAGED, THEY SHALL BE RE-INSTATED BY THE CONTRACTOR AT NO COST TO THE PRINCIPAL.

### 2. STABILISATION OF DISTURBED AREAS.

- STABILISATION OF DISTURBED AREAS SHALL BE IN ACCORDANCE WITH COUNCIL'S SPECIFICATION FOR GRASSING AND/OR SPECIFICATION FOR LANDSCAPE WORKS. THE FOLLOWING SHALL BE APPLIED FOR THE CONTROL OF EROSION AND SEDIMENTATION:
  - (a) STABILISATION OF DENuded AREAS SHALL COMMENCE AS SOON AS POSSIBLE AFTER THE AREAS HAVE BEEN DISTURBED.
  - (b) ALL STABILISATION MEASURES SHALL BE UNDERTAKEN PRIOR TO THE END OF THE MAINTENANCE PERIOD.

### 3. MAINTENANCE

- ALL SEDIMENT AND EROSION CONTROL DEVICES SHALL BE MAINTAINED IN A SATISFACTORY WORKING ORDER THROUGHOUT THE CONTRACT. MAINTENANCE AND DEFECTS LIABILITY PERIODS OR UNTIL SUCH EARLIER TIME AS THE AREA HAS BEEN STABILISED AND THE SUPERINTENDENT DIRECTS THAT THE DEVICE BE REMOVED.
- THE CONTRACTOR SHALL INSTALL ALL DEVICES AFTER EACH STORM FOR STRUCTURAL DAMAGE OR CLOGGING BY SILT AND OTHER DEBRIS AND MAKE PROMPT REPAIRS OR REPLACEMENT.

### 4. SEDIMENT CONTROL DEVICES (S.C.D.)

- THESE SHALL BE CONSTRUCTED AT INLETS TO STORMWATER SYSTEMS TO TRAP THE SEDIMENT IN RUNOFF. SECTIONS 11.3.02/03/04/06 OF THE N.S.W. DEPARTMENT OF HOUSING CONSTRUCTION SPECIFICATION, 1989 EDITION, SHALL APPLY.

## PLANTING NOTES

- SUBGRADE TO BE CULTIVATED TO A MINIMUM DEPTH OF 100mm.
- PLANTING AREAS TO BE EXCAVATED TO A MINIMUM DEPTH OF 500mm AND FILLED WITH PREMIUM GRADE GARDEN SOIL.
- INORGANIC MULCH LAYER MINIMUM 75mm DEPTH IS TO BE SPREAD THROUGHOUT ALL PLANTING AREA.
- GARDEN AREA TO BE WATERED TWICE A WEEK FOR 3 MONTHS, OR AS REQUIRED TO MAINTAIN HEALTHY GARDEN.
- QUANTITIES OR SIZE OF PLANTS SPECIFIED ARE NOT TO BE DECREASED TO ENSURE ADEQUATE ESTABLISHMENT.

## UNDERGROUND UTILITY SERVICES

- THE LOCATION OF UNDERGROUND UTILITY SERVICES SHOWN ON THIS PLAN ARE INDICATIVE ONLY. COUNCIL CANNOT GUARANTEE THEIR ACCURACY.
- PRIOR TO CONSTRUCTION, IT IS THE RESPONSIBILITY OF THE CONTRACTOR TO CARRY OUT THEIR OWN SERVICES SEARCH BY CONTACTING DIAL BEFORE YOU DIG (PH: 1100 OR WWW.1100.COM.AU). THE CONTRACTOR MUST CHECK THE LOCATION AND DEPTH OF ALL SERVICES PRIOR TO THE COMMENCEMENT OF WORKS.
- ALL SERVICES AFFECTED BY NEW WORK TO BE ADJUSTED AS REQUIRED TO SUIT NEW SURFACE LEVELS. (TO THE REQUIREMENTS OF THE RELEVANT SERVICE AUTHORITY).
- NO SERVICE SURFACE FITTINGS ARE TO BE COVERED.
- ALL PERMITS REQUIRED MUST BE OBTAINED FROM THE RELEVANT SERVICE AUTHORITY PRIOR TO COMMENCEMENT OF WORKS.
- ANY DAMAGE TO SERVICES SHALL BE RECTIFIED BY THE CONTRACTOR OR THE RELEVANT AUTHORITY AT NO COST TO COUNCIL.

## PROTECTING SURVEY INFRASTRUCTURE

- SURVEY MARKS SHALL BE PRESERVED AT ALL TIMES. WHERE PRESERVATION IS NOT POSSIBLE, THE PROJECT MANAGER SHALL BE NOTIFIED & CONSENT RECEIVED PRIOR TO THEIR REMOVAL. THE CONTRACTOR SHALL BE RESPONSIBLE FOR COMPLIANCE WITH THE SURVEYOR'S GENERAL'S DIRECTION NO.11 "PRESERVATION OF SURVEY INFRASTRUCTURE" AVAILABLE FROM LAND REGISTRY SERVICES NSW WEBSITE.

## CONCRETE

- ALL WORKMANSHIP AND MATERIALS SHALL BE IN ACCORDANCE WITH AS 3600 CURRENT EDITION WITH AMENDMENTS EXCEPT WHERE VARED BY THE CONTRACT DOCUMENTS.
- CONCRETE QUALITY.

ELEMENT	SUMP	MAX AGGREGATE SIZE	CEMENT TYPE	CEMENT GRADE
ALL	80mm	20mm	GP	25MPa

- NO ADMIXTURES SHALL BE USED WITHOUT THE APPROVAL OF THE ENGINEER.
- CLEAR CONCRETE COVER TO REINFORCEMENT SHALL BE AS FOLLOWS UNLESS OTHERWISE SHOWN:

ELEMENT	SURFACE OF MEMBER IN INTERIOR ENVIRONMENT	SURFACE OF MEMBER IN ABOVE GROUND EXTERIOR ENVIRONMENT	SURFACE OF MEMBER IN CONTACT WITH GROUND (1)	SURFACE OF MEMBER IN WATER
ALL	35	45	55	75

- NOTE:**
- COVER MAY BE REDUCED BY 10mm IF THE SURFACE IS PROTECTED BY A DAMP-PROOF MEMBRANE.
  - SLABS EXPOSED TO CORROSIVE VAPOURS, CORROSIVE GROUND WATER, SEA WATER, OR SPRAY ARE TO HAVE REINFORCEMENT COVER AS NOTED ON THE DRAWINGS.

- SIZES OF CONCRETE ELEMENTS DO NOT INCLUDE THICKNESS OF APPLIED FINISHES.
- CONSTRUCTION JOINTS WHERE NOT SHOWN SHALL BE LOCATED TO THE APPROVAL OF THE ENGINEER.
- BEAM DEPTHS ARE WRITTEN FIRST AND INCLUDE SLAB THICKNESS IF ANY.

## SURVEY LEGEND

- SYMBOLS**
- STATE SURVEY MARK
  - PERMANENT SURVEY MARK
  - SURVEY STATION
  - DRILL HOLE & BING
  - DRILLED HOLE
  - SURVEY NAIL
  - SIGN
  - SILENT COP
  - COLUMN
  - BOLLARD
  - HYDRANT
  - POWER POLE
  - LIGHT POLE
  - ELECTRICITY & LIGHT POLE
  - ELECTRICITY FILLER
  - PHONE BOOTH
  - MAL BOX
  - TELECOMM. SERVICE COVER
  - TELECOMMUNICATION PILLAR
  - RUBBER SIGN
  - MANHOLE (STORMWATER/SEWER)
  - MANHOLE (TRIANGULAR/SQUARE)
  - WATER STOP VALVE
  - WATER METER
  - GAS VALVE
  - OPTUS PIT / RAS PIT
  - PARKING METER
  - UNDERGROUND SERVICE COVER
  - SEWER LAMP HOLE
  - TRAFFIC LIGHT BOX
  - TRAFFIC LIGHTS
  - TREES / SHRUB

LINEMARKING SCHEDULE				
LINE TYPE	QUANTITY	POT SIZE	LOCATION	
WHITE THERMOPLASTIC LINEMARKING E1	13.4m	AS SHOWN		
YELLOW 150mm WIDE PAINTED LINEMARKING	9.1m	AS SHOWN		
WHITE "LOOK" PAINTED WORDING	1 ITEM	AS SHOWN		
WHITE THERMOPLASTIC PIANO KEY "PREMARK"	12.2m	AS SHOWN		
WHITE THERMOPLASTIC TRANSVERSE MARKING PX	6.1m	AS SHOWN		
WHITE THERMOPLASTIC BICYCLE LOGO PS-2	1 ITEM	AS SHOWN		

KERB BLISTER PLANTING SCHEDULE					
LEGEND	SPECIES	DENSITY	QUANTITY	POT SIZE	LOCATION
	JUNIPERUS CONFERTA	0.5 CTS	42	140mm dia.	KERB BLISTERS
	HORIZONTALIS	0.6 CTS	2	140mm dia.	FOOTPATH
	GAZANIA TOMENTOSA	0.6 CTS	2	140mm dia.	FOOTPATH

SIGNPOSTING SCHEDULE					
SIGN NO.	QUANTITY	STEM TYPE	POT SIZE	LOCATION	
W6-2A	2	STANDARD STEM	AS SHOWN		
W8-2A	2	STANDARD STEM	AS SHOWN		
D4-1-2A	2	STANDARD SHORT STEM	AS SHOWN		

SURVEY STATION COORDINATES			
STATION	EASTING	NORTHING	ELEVATION
STN1	500.000	500.000	33.186
STN2	505.252	510.375	33.200
STN3	465.167	510.414	31.485
STN4	466.585	490.742	31.529

MATERIAL SCHEDULE			
MATERIALS	QUANTITY	POT SIZE	LOCATION
150mm x 100mm x 4mm GALVANISED RHS STEEL PIPE	1.00m	AS SHOWN	
NOMINAL 10-20mm FREE DRAINING GRANULAR BACKFILL	0.30m <sup>3</sup>	AS SHOWN	
GEOTEXILE FILTER FABRIC	4.00m <sup>2</sup>	AS SHOWN	

UNLESS DETAILED ON THIS DRAWING ALL WORK SHALL CONFORM TO

**NOTE**  
ALL DIMENSIONS ARE IN MILLIMETERS UNLESS OTHERWISE SHOWN

**IMPORTANT**  
IN CASE OF EMERGENCY, CONTACT THE FOLLOWING SERVICE AUTHORITIES; IF THEIR SERVICES ARE INVOLVED/AFFECTED

AUTHORITY	CONTACT NO.	SERVICE TYPE
ARNET PTY LTD	1300 275 662	FIBRE OPTIC ASSETS
AUSDRG	02 4951 0819	LOW VOLTAGE LINE
JEMENA GAS SOUTH	1300 880 906	PRIMARY & DISTRIBUTION
NBN CO.	1800 626 329	BURIED FIBRE OPTIC CABLES
NEXTGEN	1800 030 532	BURIED FIBRE OPTIC CABLES
OPTUS	1800 505 777	BURIED FIBRE OPTIC CABLES
SYDNEYWATER	13 20 92	WATER & SEWER LINES
TELSTRA	1800 653 935	BURIED CABLES
VERIZON	02 9434 5000	BURIED CABLES

- NOTES:**
- ALL SIGNAGE IS TO BE INSTALLED TO TNSW GUIDELINES AND IN ACCORDANCE WITH AS1742
  - RETAIN ALL EXISTING SIGNAGE UNLESS OTHERWISE NOTED
  - ALL PROPOSED LINE MARKINGS TO BE PAINTED TO RMS SPECIFICATION R141-"PAVEMENT MARKING"

**NOTE**  
ALL SIGNS AND LINES TO REMAIN UNLESS STATED OTHERWISE NOTED.

**IMPORTANT**  
ALL KERB RAMPS TO REMAIN UNLESS STATED OTHERWISE

**NOTE**  
CONTRACTOR TO LOCATE ALL HOUSE SERVICES, SUCH AS STORMWATER OUTLET, GAS, WATER, TELEPHONE, ETC. PRIOR TO CONSTRUCTION AND SERVICES TO BE LOWERED AS REQUIRED

**NOTE**  
WATER, SEWER, TELSTRA & ELECTRICITY SERVICES IN THE VICINITY OF WORKS, CONTRACTOR TO CONTACT SYDNEY WATER, TELSTRA & ENERGY AUSTRALIA PRIOR TO EXCAVATION

**NOTE**  
CONTRACTOR TO REINSTATE ALL KERB & GUTTER, ROAD PAVEMENT AND FOOTPATHS AFFECTED BY WORKS TO INNER WEST COUNCIL STANDARD AND TO THE SATISFACTION OF THE PROJECT MANAGER

**NOTE**  
SURFACE FITTINGS OF UNDERGROUND SERVICES ARE TO FINISH FLUSH WITH THE NEW SURFACES

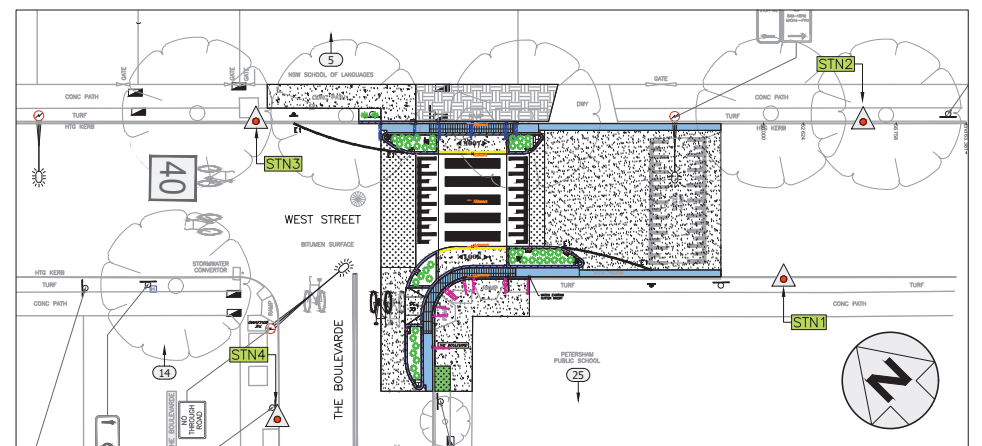

**SURVEY STATION PLAN**  
NOT TO SCALE

**WEST STREET, PETERSHAM**  
AT THE BOULEVARDE  
PROPOSED RAISED PEDESTRIAN CROSSING  
NOTES & SCHEDULES

PROJECT NO. 303082

SHEET NO. 2 of 18

PLAN NO. 10241

SHEET REF #

CHECKED & APPROVED	SURVEYED BY	DESIGNED BY	DRAWN BY
[Signature]	ADAM DILLON	JONATHAN WENG	JONATHAN WENG
	06-02-23	28-06-23	28-06-23
APPROVED FOR CONSTRUCTION			
[Signature]			

<b>INNER WEST</b>	
2-14 FISHER STREET, PETERSHAM NSW 2049	
Ph. 02 8992 5000	
PO Box 14 PETERSHAM	
4 council@innerwest.nsw.gov.au	
http://www.innerwest.nsw.gov.au	

SURV. GEN.	COORDINATE SYSTEM	SCALES (ORIGINAL A1)	NOTICES	DATE
R.M.S. A.G.L. / SHELL PIPELINES SYDNEY WATER TELSTRA / OPTUS AUSDRG	ASSUMED	N.A.		
NOTICE OF ENTRY KERB & GUTTER				

REV.	DATE	DESCRIPTION	APPROV.

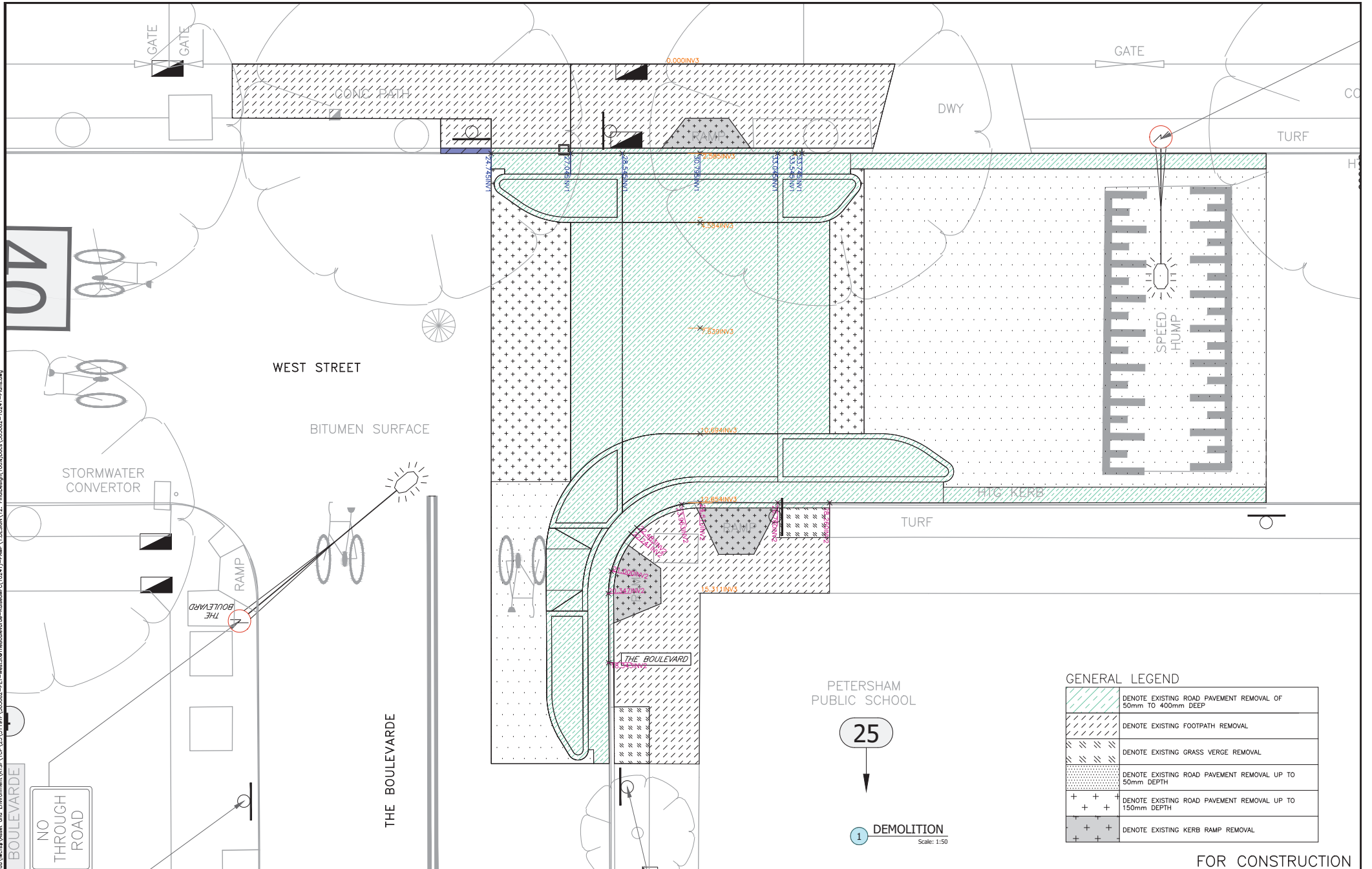

**GENERAL LEGEND**

	DENOTE EXISTING ROAD PAVEMENT REMOVAL OF 50mm TO 400mm DEEP
	DENOTE EXISTING FOOTPATH REMOVAL
	DENOTE EXISTING GRASS VERGE REMOVAL
	DENOTE EXISTING ROAD PAVEMENT REMOVAL UP TO 50mm DEPTH
	DENOTE EXISTING ROAD PAVEMENT REMOVAL UP TO 150mm DEPTH
	DENOTE EXISTING KERB RAMP REMOVAL

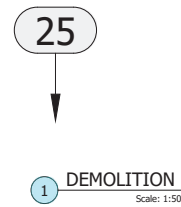

FOR CONSTRUCTION

CHECKED & APPROVED  20/11/23	SURVEYED BY ADAM DILLON 06-02-23		SURV. GEN. R.M.S. A.G.L. / SHELL PIPELINES SYDNEY WATER TELSTRA / OPTUS AUSGRID	COORDINATE SYSTEM ASSUMED SCALES (ORIGINAL A1) 1:100	PROJECT NO. 303082	SHEET NO. 3 of 18

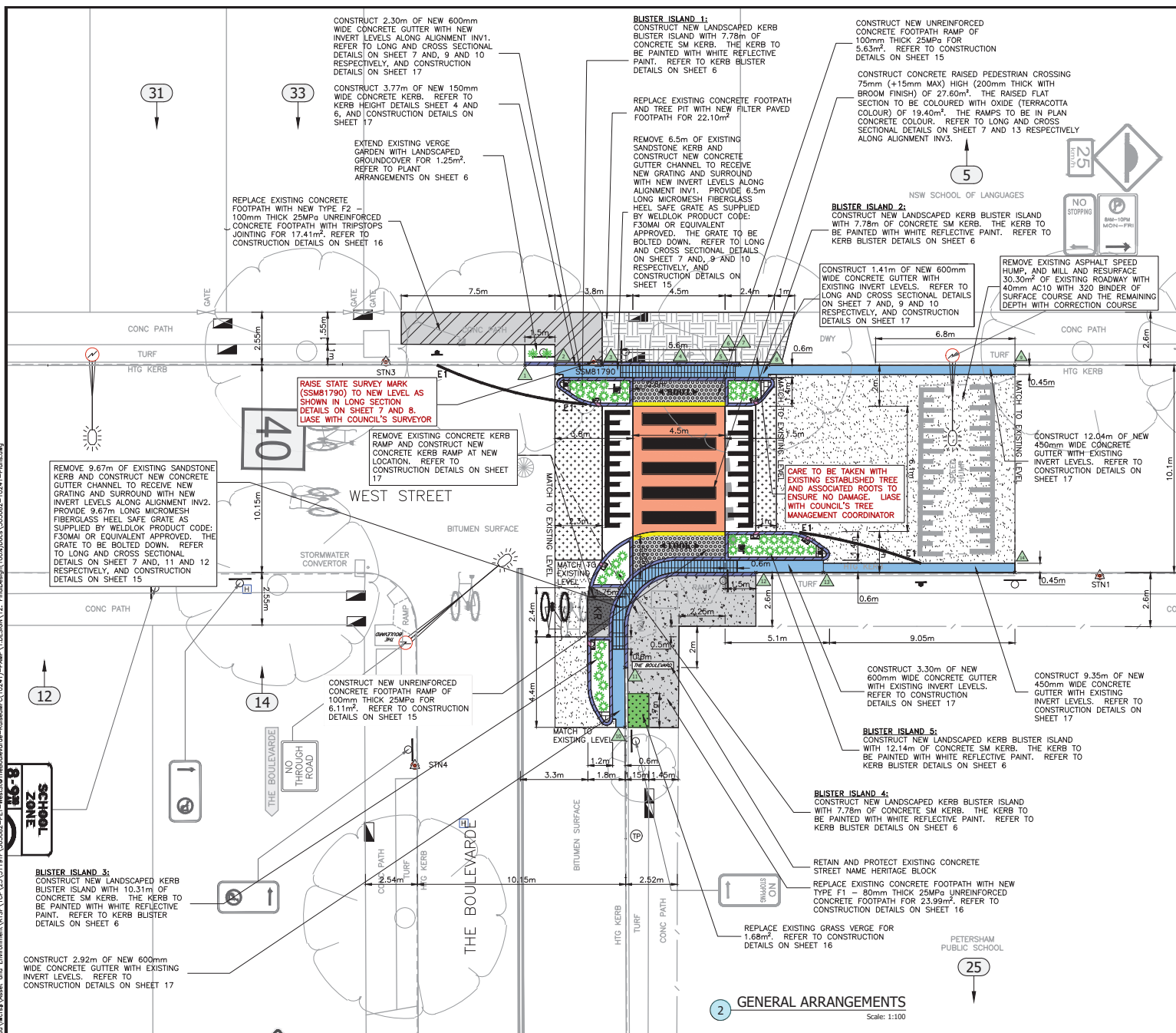

### GENERAL LEGEND

	DENOTE NEW 450mm OR 600mm WIDE CONCRETE GUTTER
	DENOTE NEW 150mm WIDE CONCRETE KERB OF VARYING HEIGHTS. REFER TO SHEET 4 AND 6 FOR KERB HEIGHT AT DESIGN CHANGES
	DENOTE NEW CONCRETE FOOTPATH (TYPE F1 - 80mm THICK UNREINFORCED)
	DENOTE NEW CONCRETE FOOTPATH (TYPE F2 - 100mm THICK WITH TRIPSTOPS JOINTING AT 1.5m CTS)
	DENOTE NEW CONCRETE FOOTPATH RAMP (TYPE F3 - 100mm THICK UNREINFORCED)
	DENOTE NEW FILTER PAVED FOOTPATH (70mm THICK WITH GREY COLOUR MATCHING SURROUNDING CONCRETE)
	DENOTE NEW CONCRETE KERB RAMP
	DENOTE NEW CONCRETE RAISED PEDESTRIAN CROSSING
	DENOTE NEW LANDSCAPED KERB BLUSTER WITH CONCRETE KERB. REFER TO KERB BLUSTER DETAILS ON SHEET 6 AND 14
	DENOTE NEW TOPSOIL & TURF (BUFFALO OR SIMILAR)
	DENOTE NEW MICROMESH FIBERGLASS HEEL SAFE GRATE
	DENOTE NEW VERGE GARDEN (MAX PLANT HEIGHT OF 0.5m AT FULL MATURITY) WITH NATIVE GRASSES. REFER TO PLANT ARRANGEMENTS ON SHEET 6

### KERB RECONSTRUCTION SCHEDULE

START	END	LENGTH (m)
1	2	1.46
2	4	6.05
4	5	2.25
5	6	0.50
6	7	0.20
11	12	9.92

### GUTTER RECONSTRUCTION SCHEDULE

START	END	LENGTH (m)
2	3	2.30
3	7	6.70
7	8	1.80
8	9	12.04
10	11	2.92
11	12	9.92
12	13	3.29
13	14	9.35

NOTE: ALL EXISTING PRIVATE STORMWATER LINES (BETWEEN THE FRONT BOUNDARY AND GUTTER) THAT ARE DAMAGED ARE TO BE REPLACED AS PART OF THE WORKS

### 2 GENERAL ARRANGEMENTS

Scale: 1:100

FOR CONSTRUCTION

CHECKED & APPROVED  
  
 20/1/23

APPROVED FOR CONSTRUCTION  
  
 22/1/23

**INNER WEST**

2-14 FISHER STREET, PETERSHAM NSW 2049  
 Ph: 02 9392 5000  
 PO Box 14 PETERSHAM  
 council@innerwest.nsw.gov.au  
 https://www.innerwest.nsw.gov.au

DESIGNED BY  
 ADAM DILLON  
 06-02-23

DRAWN BY  
 JONATHAN WENG  
 28-06-23

SURV. GEN.  
 R.M.S.  
 A.G.L. / SHELL PIPELINES  
 SYDNEY WATER  
 TELSTAR / OPTUS  
 AUSGRID

NOTICE OF ENTRY  
 KERB & GUTTER  
 NOTICES

DATE

COORDINATE SYSTEM	ASSUMED		
SCALES (ORIGINAL A1)	1:100		
REV.	DATE	DESCRIPTION	APPROV.

PROJECT NO. 303082 SHEET NO. 4 of 18

PLAN NO. 10241

SHEET REF #

WEST STREET, PETERSHAM  
 AT THE BOULEVARDE  
 PROPOSED RAISED PEDESTRIAN CROSSING  
 GENERAL LAYOUT - FOOTPATH, KERB, GUTTER & CROSSING

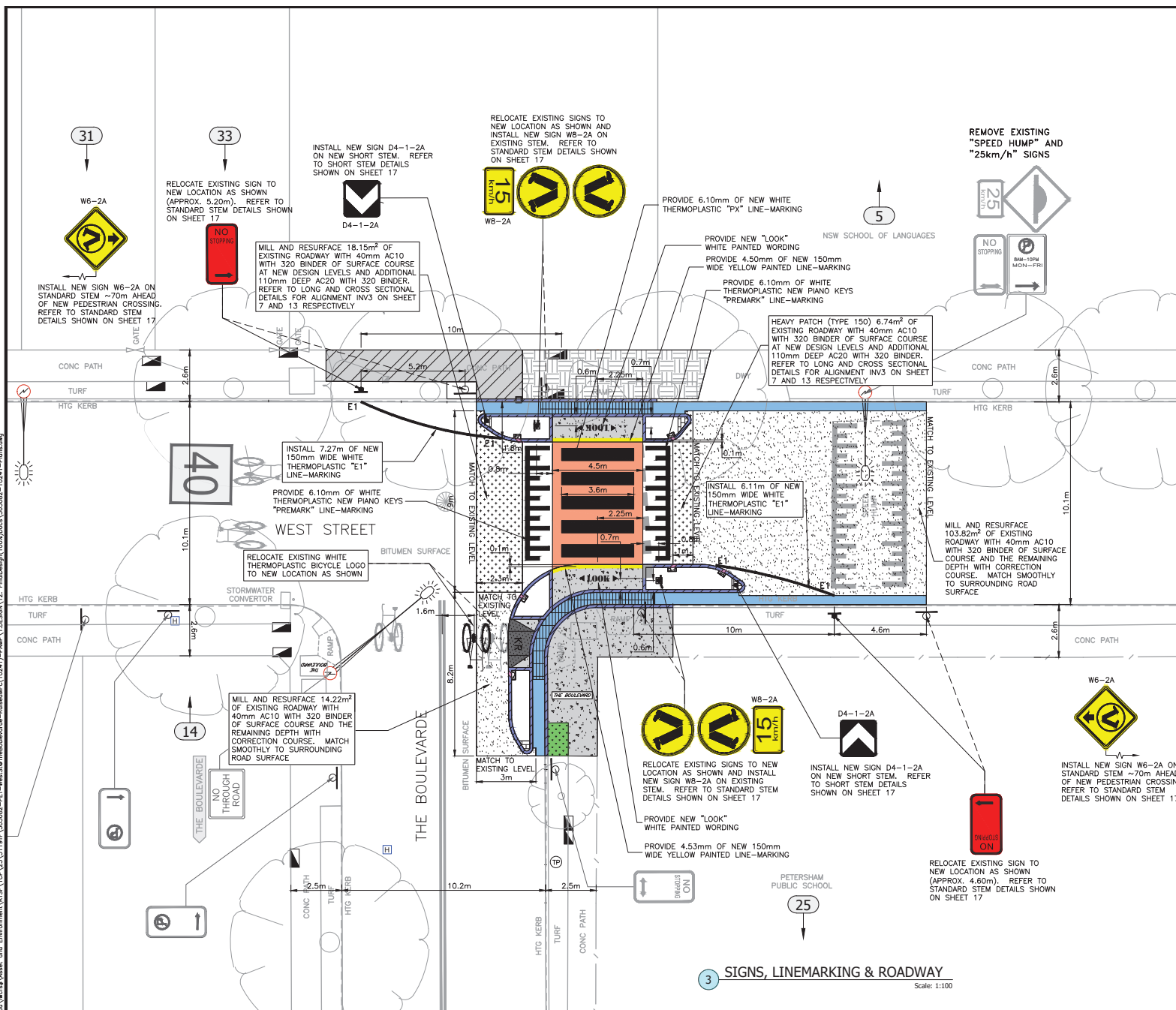

### GENERAL LEGEND

	DENOTE NEW 150mm WIDE EDGE LINE E1 (WHITE THERMOPLASTIC PAINT) TO TNSW QA SPECIFICATION R145 "PAVEMENT MARKING"
	DENOTE NEW 150mm WIDE YELLOW PAINTED LINE-MARKING
	DENOTE NEW "LOOK" WHITE PAINTED WORDING
	DENOTE NEW PIANO KEY "PREMARK" (WHITE THERMOPLASTIC PAINT) TO TNSW QA SPECIFICATION R145 "PAVEMENT MARKING"
	DENOTE NEW PX PEDESTRIAN CROSSING TRANSVERSE MARKING (WHITE THERMOPLASTIC PAINT) TO TNSW QA SPECIFICATION R145 "PAVEMENT MARKING"
	DENOTE NEW PS-2 BICYCLE LOGO (WHITE THERMOPLASTIC PAINT) TO TNSW QA SPECIFICATION R145 "PAVEMENT MARKING"
	DENOTE NEW SIGN ON EXISTING OR NEW STEM. REFER TO STEM DETAILS ON SHEET 17
	DENOTE NEW EXISTING SIGN
	DENOTE HEAVY PATCHING (TYPE 150) WITH 40mm AC10 (WITH 320 BINDER) AT NEW DESIGN LEVELS AND ADDITIONAL 110mm DEEP AC20 (WITH 320 BINDER). REFER TO LONG AND CROSS SECTIONAL DETAILS FOR ALIGNMENT INV3 ON SHEET 7 AND 13 RESPECTIVELY, AND HEAVY PATCHING DETAILS ON SHEET 15
	DENOTE MILL OFF EXISTING AC WEARING COURSE AND RESEAL WITH 40mm AC10 (WITH 320 BINDER) AT EXISTING LEVELS

### LINEMARKING SCHEDULE

LINE TYPE	QUANTITY	LOCATION
WHITE THERMOPLASTIC LINEMARKING E1	13.4m	AS SHOWN
YELLOW 150mm WIDE PAINTED LINEMARKING	9.1m	AS SHOWN
WHITE "LOOK" PAINTED WORDING	1 ITEM	AS SHOWN
WHITE THERMOPLASTIC PIANO KEY "PREMARK"	12.2m	AS SHOWN
WHITE THERMOPLASTIC TRANSVERSE MARKING PX	6.1m	AS SHOWN
WHITE THERMOPLASTIC BICYCLE LOGO PS-2	1 ITEM	AS SHOWN

### SIGNPOSTING SCHEDULE

SIGN NO.	QUANTITY	STEM TYPE	LOCATION
W6-2A	2	STANDARD STEM	AS SHOWN
W8-2A	2	STANDARD STEM	AS SHOWN
D4-1-2A	2	STANDARD SHORT STEM	AS SHOWN

NOTE: ALL EXISTING STREET SIGNS/STEMS THAT ARE FADED OR DAMAGED ARE TO BE REPLACED AS PART OF THE WORKS

- NOTES:
- ALL SIGNAGE IS TO BE INSTALLED TO TNSW GUIDELINES AND IN ACCORDANCE WITH AS1742
  - RETAIN ALL EXISTING SIGNAGE UNLESS OTHERWISE NOTED
  - ALL PROPOSED LINE MARKINGS TO BE PAINTED TO RMS SPECIFICATION R141 - "PAVEMENT MARKING"

### 3 SIGNS, LINEMARKING & ROADWAY

Scale: 1:100

CHECKED & APPROVED  
  
 20/11/23

APPROVED FOR CONSTRUCTION  
  
 22/11/23

**INNER WEST**

2-14 FISHER STREET, PETERSHAM NSW 2049  
 Ph: (02) 9392 5000  
 Post: PO Box 14 PETERSHAM  
 Email: council@innerwest.nsw.gov.au  
 Web: https://www.innerwest.nsw.gov.au

SURV. GEN.  
 R.M.S.  
 A.G.L. / SHELL PIPELINES  
 SYDNEY WATER  
 TELSTRA / OPTUS  
 AUSGRID

NOTICE OF ENTRY  
 KERB & CUTTER  
 NOTICES

DATE

COORDINATE SYSTEM  
 ASSUMED

SCALES (ORIGINAL A1)  
 1:100

REV.	DATE	DESCRIPTION	APPROV.

WEST STREET, PETERSHAM  
 AT THE BOULEVARDE  
 PROPOSED RAISED PEDESTRIAN CROSSING  
 GENERAL LAYOUT - SIGNS, LINEMARKING & ROADWAY

PROJECT NO. 303082  
 SHEET NO. 5 of 18  
 PLAN NO. 10241  
 SHEET REF #

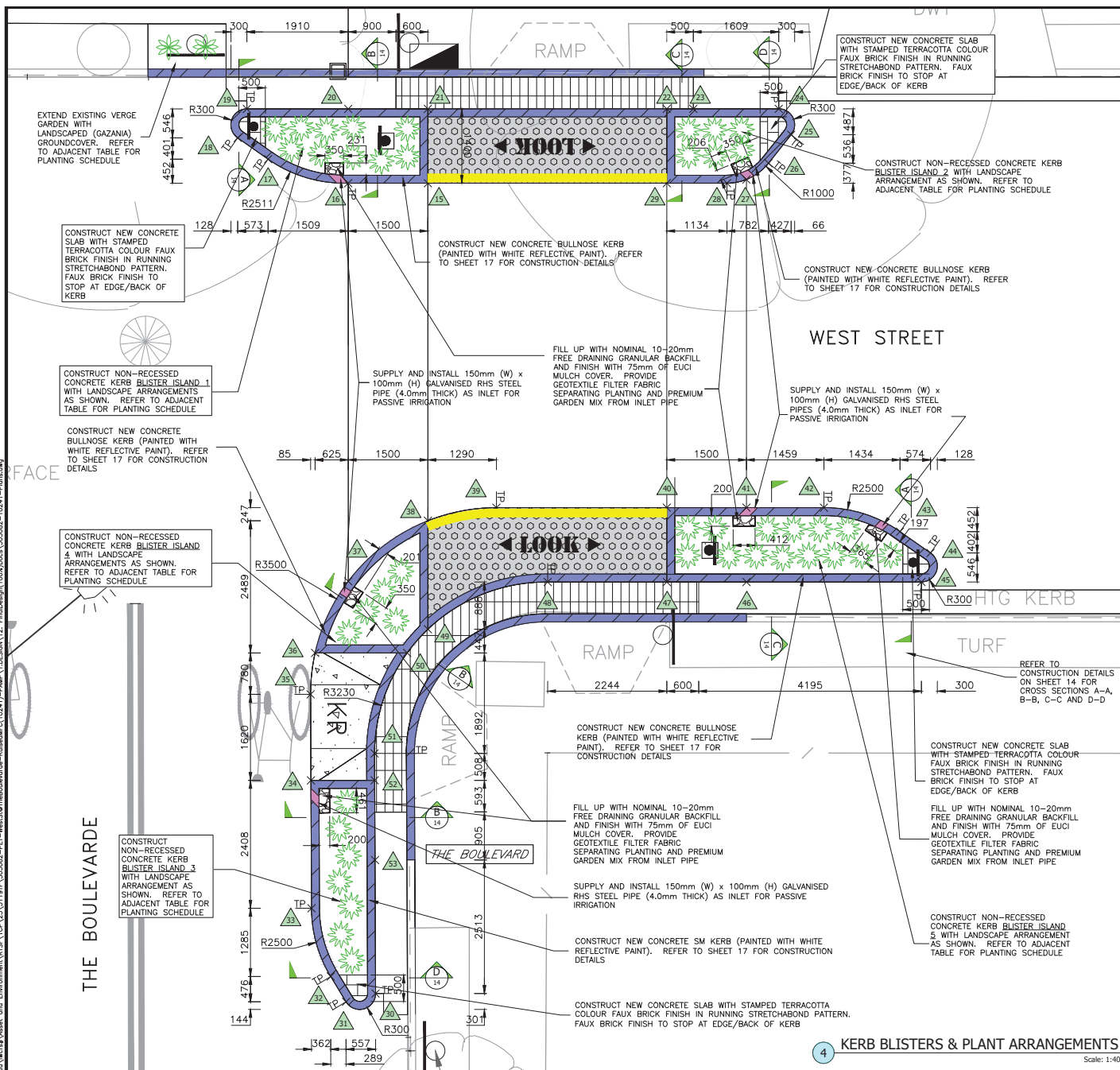

×	INVERT SETOUT CO-ORDS (X/Y)	CONCRETE KERB HEIGHT
15	477.218/508.262	75mm
16	475.718/508.262	150mm
17	474.209/508.715	150mm
18	473.636/509.116	150mm
19	473.808/509.662	150mm
20	475.718/509.662	150mm
21	477.218/509.662	150mm
22	481.718/509.662	174mm
23	482.218/509.662	150mm
24	483.826/509.663	150mm
25	484.061/509.176	150mm
26	483.634/508.639	150mm
27	483.218/508.332	150mm
28	482.852/508.263	150mm
29	481.718/508.262	75mm

×	INVERT SETOUT CO-ORDS (X/Y)	CONCRETE KERB HEIGHT
30	476.233/493.005	150mm
31	475.676/492.848	150mm
32	475.388/493.324	150mm
33	475.026/494.609	150mm
34	475.016/497.017	150mm
35	475.009/498.638	40mm
36	475.093/499.417	150mm
37	475.719/500.766	150mm
38	477.218/501.906	75mm
39	478.508/502.153	0mm
40	481.718/502.153	75mm
41	483.218/502.153	150mm
42	484.677/502.153	150mm
43	486.111/501.701	150mm
44	486.685/501.299	150mm
45	486.513/500.754	150mm
46	483.219/500.753	150mm
47	481.719/500.753	150mm
48	479.474/500.753	150mm
49	477.219/499.864	150mm
50	476.828/499.417	150mm
51	476.214/497.526	150mm
52	476.216/497.018	150mm
53	476.222/495.517	150mm

MATERIAL SCHEDULE		
MATERIALS	QUANTITY	LOCATION
150mm x 100mm x 4mm GALVANISED RHS STEEL PIPE	1.00m	AS SHOWN
NOMINAL 10-20mm FREE DRAINING GRANULAR BACKFILL	0.30m <sup>3</sup>	AS SHOWN
GEOTEXTILE FILTER FABRIC	4.00m <sup>2</sup>	AS SHOWN

KERB BLISTER PLANTING SCHEDULE					
LEGEND	SPECIES	DENSITY	QUANTITY	POT SIZE	LOCATION
	JUNIPERUS CONFERTA HORIZONTALIS	● 0.5 CTS	42	140mm dia.	KERB BLISTERS
	GAZANIA TOMENTOSA	● 0.6 CTS	2	140mm dia.	FOOTPATH

**WORK METHOD STATEMENT FOR NEW CIVIC GARDEN LANDSCAPE AREA:**

- SUBGRADE TO BE CULTIVATED AND COMPACTED TO MINIMUM DEPTH OF 100mm
- PLANTING AREAS TO BE EXCAVATED TO A MINIMUM DEPTH OF 300mm BELOW EXISTING FOOTPATH SURFACE LEVEL EXCEPT 0.5m EXCLUSION ZONE AROUND TREE (BE CAREFUL NOT TO CAUSE DAMAGE TO TREE ROOTS)
- SPRAY AREA WITH HERBICIDE (E.G. ROUNDUP OR BIO 180 AS AGREED WITH COUNCIL)
- IN LOCATIONS OF NEW PLANTS, ADD 300mm OF PREMIUM GRADE GARDEN SOIL
- PLANT OUT LANDSCAPE AREA WITH PLANTS AS SPECIFIED
- EUCI MULCH LAYER MINIMUM 50mm DEPTH IS TO BE SPREAD THROUGHOUT ALL PLANTING AREA
- GARDEN AREA TO BE WATERED TWICE A WEEK BY THE CONTRACTOR FOR 3 MONTHS, OR AS REQUIRED TO MAINTAIN A HEALTHY GARDEN

4 KERB BLISTERS & PLANT ARRANGEMENTS Scale: 1:40

CHECKED & APPROVED  
  
 20/17/23

DESIGNED BY  
 JONATHAN WENG  
 28-06-23

APPROVED FOR CONSTRUCTION  
  
 20/17/23

**INNER WEST**

2-14 FISHER STREET, PETERSHAM NSW 2049  
 Ph: 02 9392 5000  
 P.O. Box 14 PETERSHAM  
 council@innerwest.nsw.gov.au  
 Web: https://www.innerwest.nsw.gov.au

SURV. GEN.	COORDINATE SYSTEM
R.M.S.	ASSUMED
A.G.L. / SHELL PIPELINES	SCALES (ORIGINAL A1)
SYDNEY WATER	1:40
TELSTRA / OPTUS	
AUSGRID	
NOTICE OF ENTRY	
KERB & GUTTER	
NOTICES	DATE

REV.	DATE	DESCRIPTION	APPROV.

**WEST STREET, PETERSHAM**  
 AT THE BOULEVARDE  
 PROPOSED RAISED PEDESTRIAN CROSSING  
 GENERAL LAYOUT - KERB BLISTER & PLANT ARRANGEMENTS

PROJECT NO. 303082 SHEET NO. 6 of 18  
 PLAN NO. 10241  
 SHEET REV #

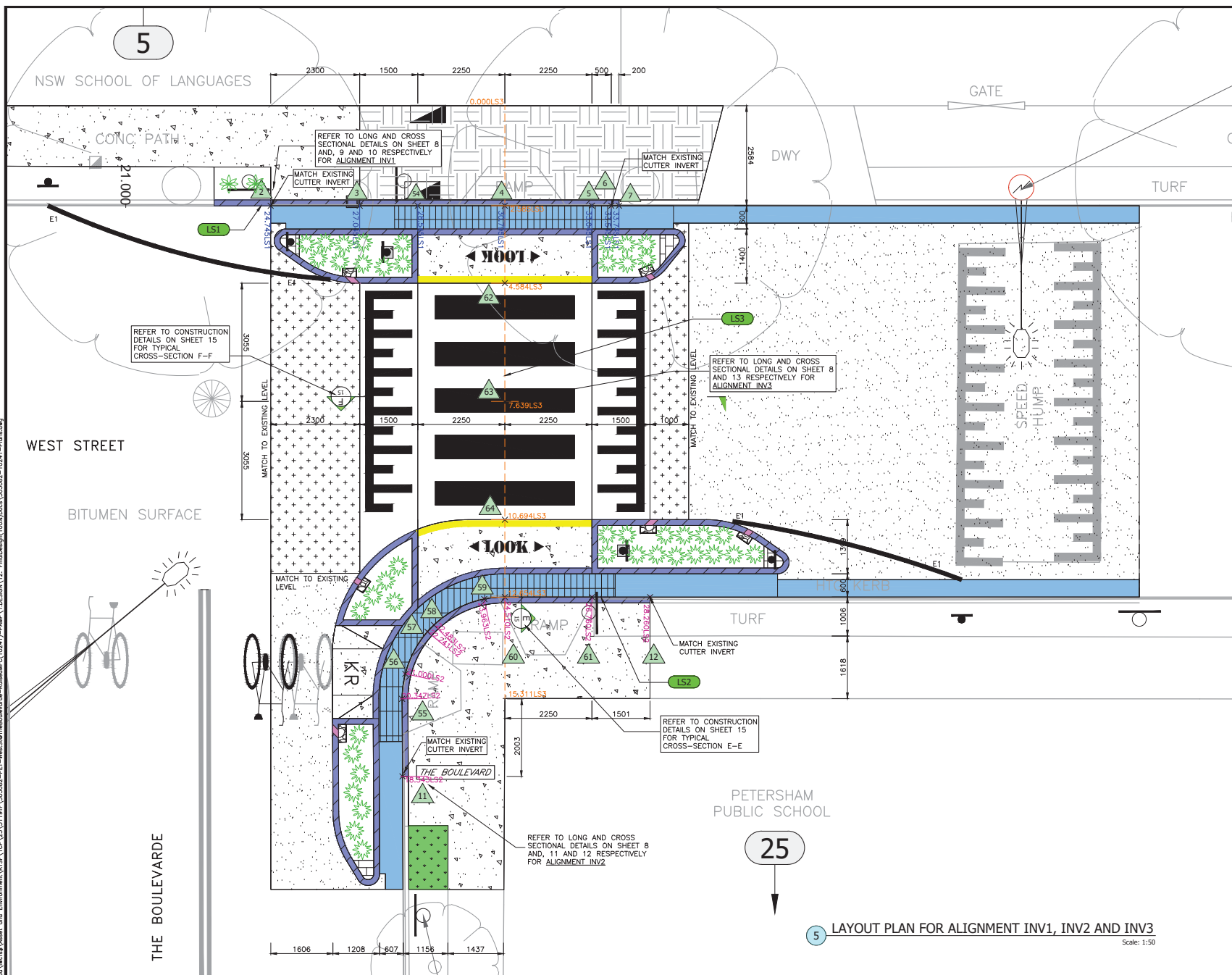

ALIGNMENT INV1 (IN FRONT OF NSW SCHOOL OF LANGUAGES)		
CH	×	INVERT SETOUT CO-ORDS (X/Y/Z)
24.745	▲	473.418/510.261/31.76
27.045	▲	475.718/510.262/31.87
28.545	▲	477.217/510.262/31.92
30.795	▲	479.467/510.262/32.01
33.045	▲	481.717/510.262/32.08
33.545	▲	482.217/510.263/32.09
33.745	▲	482.417/510.263/32.10

ALIGNMENT INV2 (IN FRONT OF PETERSHAM PUBLIC SCHOOL)		
CH	×	INVERT SETOUT CO-ORDS (X/Y/Z)
18.343	▲	476.822/495.522/31.904
20.347	▲	476.813/497.525/31.980
21.000	▲	476.894/498.172/32.009
22.241	▲	477.468/499.259/32.049
22.483	▲	477.636/499.433/32.060
23.963	▲	478.935/500.103/32.142
24.510	▲	479.469/500.153/32.180
26.760	▲	481.719/500.153/32.259
28.260	▲	483.219/500.153/32.355

ALIGNMENT INV3 (ACROSS RAISED PEDESTRIAN CROSSING)		
CH	×	CENTRELINE SETOUT CO-ORDS (X/Y/Z)
4.584	▲	479.468/508.262/32.24
7.639	▲	479.468/505.207/32.43
10.694	▲	479.468/502.153/32.41

5 LAYOUT PLAN FOR ALIGNMENT INV1, INV2 AND INV3  
Scale: 1:50

FOR CONSTRUCTION

CHECKED & APPROVED  20/1/23	SURVEYED BY ADAM DILLON 06-02-23		SURV. GEN. R.M.S. A.G.L. / SHELL PIPELINES SYDNEY WATER TELSTRA / OPTUS AUSGRID	COORDINATE SYSTEM ASSUMED SCALES (ORIGINAL A1) 1:50	PROJECT NO. 303082	SHEET NO. 7 of 18

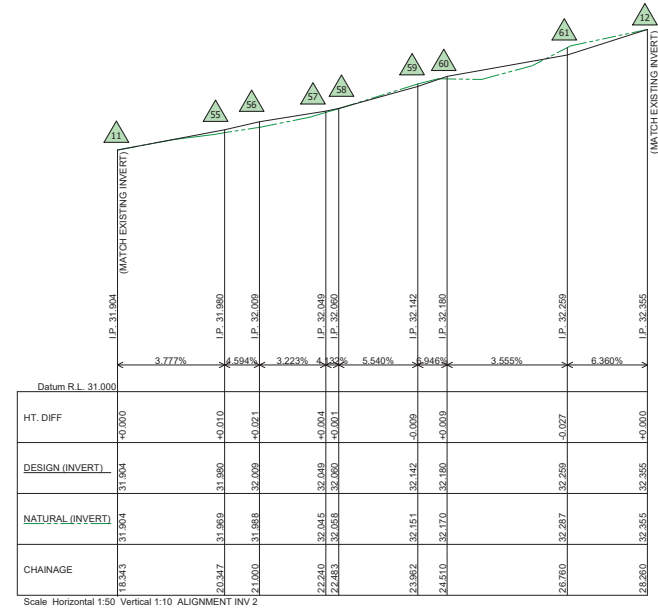
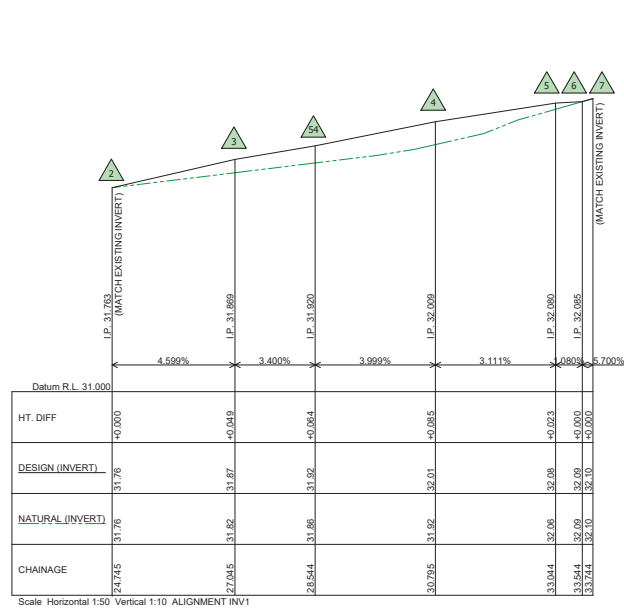

LS1 LONG SECTION FOR ALIGNMENT LS1 - IN FRONT OF NSW SCHOOL AND LANGUAGES

Scale: H1:50, V1:10

LS2 LONG SECTION FOR ALIGNMENT LS2 - IN FRONT OF PETERSHAM PUBLIC SCHOOL

Scale: H1:50, V1:10

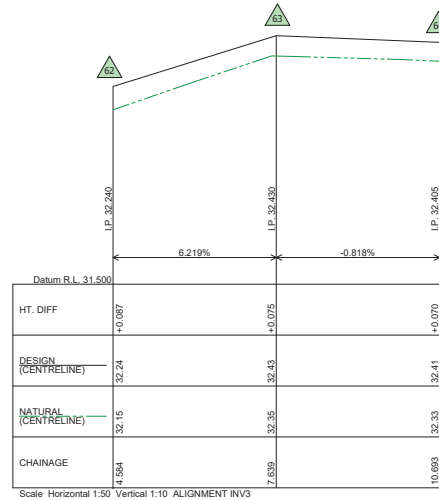

LS3 LONG SECTION FOR ALIGNMENT LS3 - ACROSS RAISED PEDESTRIAN CROSSING

Scale: H1:50, V1:10

FOR CONSTRUCTION

CHECKED & APPROVED  20/11/23	SURVEYED BY ADAM DILLON 06-02-23		SURV. GEN. R.M.S. A.G.L. / SHELL PIPELINES SYDNEY WATER TELSTRA / OPTUS AUSGRID NOTICE OF ENTRY KERB & GUTTER NOTICES	COORDINATE SYSTEM ASSUMED SCALES (ORIGINAL A1) 1:50 1:10	WEST STREET, PETERSHAM AT THE BOULEVARDE PROPOSED RAISED PEDESTRIAN CROSSING LONG SECTION DETAILS - ALIGNMENT LS1, LS2 & LS3	PROJECT NO. 303082	SHEET NO. 8 of 18
						APPROVED FOR CONSTRUCTION  20/11/23	DESIGNED BY JONATHAN WENG 28-06-23





\\ns-w02.innerwest.nsw.gov.au\cwf4\Asset and Environment\RTS\CIP\23\3119\F\303082-PE- West@TheBoulevard-Release\MFC\10241-Final\Design\12\_Final\Design\10241-Plans.dwg

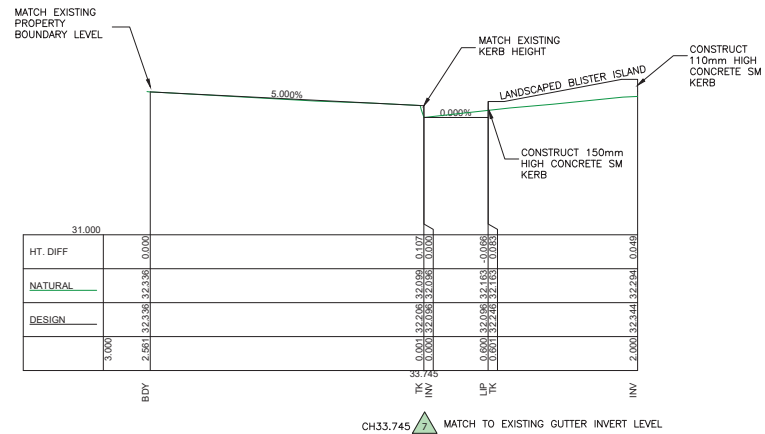

**CR1** CROSS SECTIONS FOR ALIGNMENT LS1 - IN FRONT OF NSW SCHOOL OF LANGUAGES

Scale: 1:25

LEGEND	
BDY	- PROPERTY BOUNDARY
TK	- TOP OF KERB
INV	- GUTTER INVERT
LIP	- GUTTER LIP

FOR CONSTRUCTION

CHECKED & APPROVED 20/17/23	SURVEYED BY ADAM DILLON 06-02-23		SURV. GEN. R.M.S. A.G.L. / SHELL PIPELINES SYDNEY WATER TELSTRA / OPTUS AUSGRID NOTICE OF ENTRY KERB & GUTTER NOTICES	COORDINATE SYSTEM ASSUMED SCALES (ORIGINAL A1) 1:25	WEST STREET, PETERSHAM AT THE BOULEVARDE PROPOSED RAISED PEDESTRIAN CROSSING CROSS SECTION DETAILS - ALIGNMENT LS1	PROJECT NO. 303082	SHEET NO. 10 of 18
						APPROVED FOR CONSTRUCTION 20/17/23	DESIGNED BY JONATHAN WENG 28-06-23

\\ns-002\innerwest.nsw.gov.au\projects\10241\10241\_Plan\DESIGN\12\_Final\Drawings\10241\_Plan\12\_Plan\12\_Plan.dwg - WestSt@theBoulevard-Release\FIC(10241)-PMP\12\_DESIGN\12\_Final\Drawings\10241\_Plan\12\_Plan.dwg

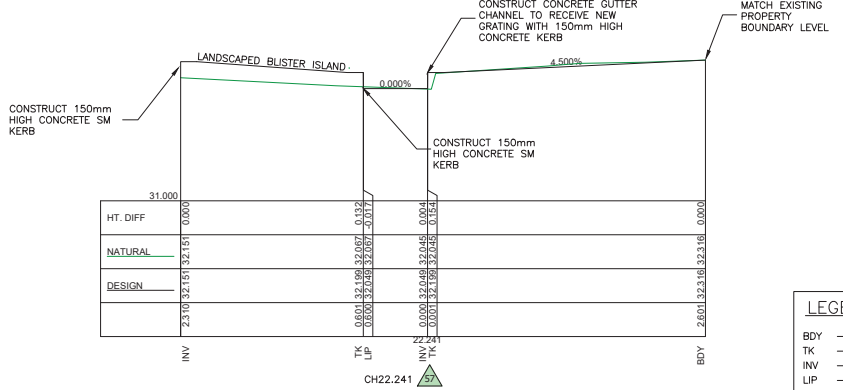
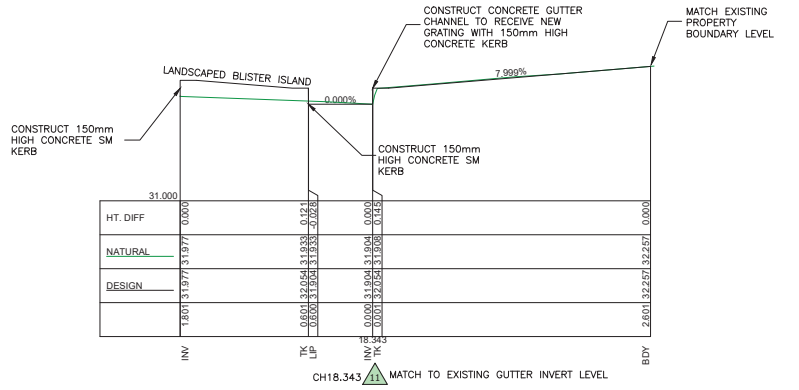
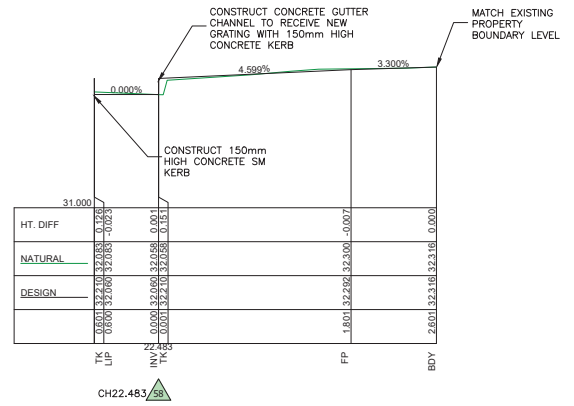
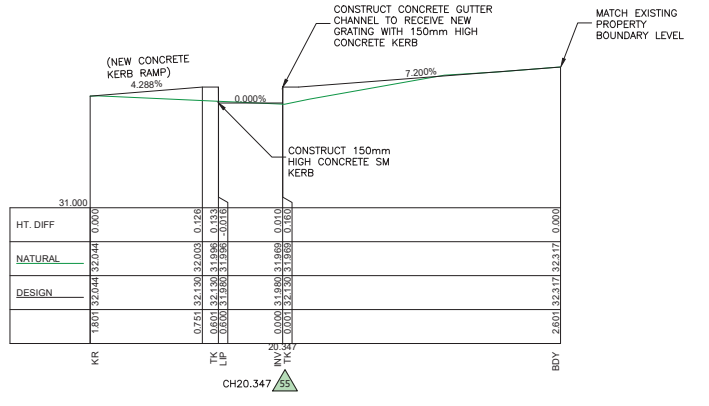
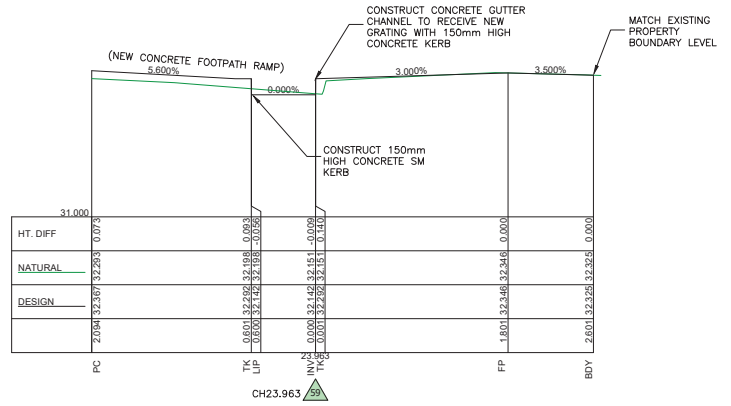
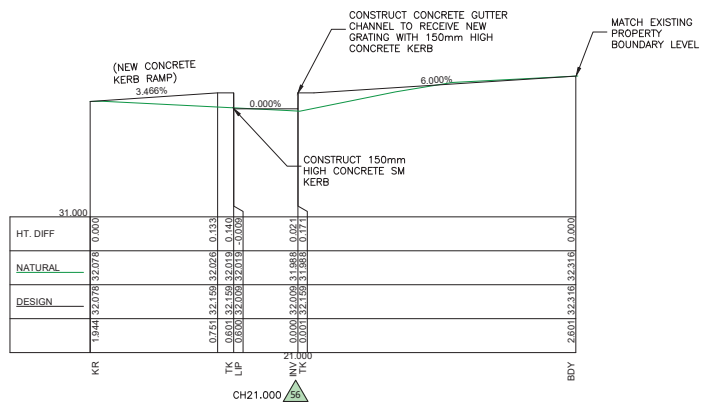

LEGEND	
BDY	- PROPERTY BOUNDARY
TK	- TOP OF KERB
INV	- GUTTER INVERT
LIP	- GUTTER LIP

**CR2 CROSS SECTIONS FOR ALIGNMENT LS2 - IN FRONT OF PETERSHAM PUBLIC SCHOOL**

Scale: 1:25

FOR CONSTRUCTION

CHECKED & APPROVED  
  
 20/11/23

DESIGNED BY  
 JONATHAN WENG  
 28-06-23

APPROVED FOR CONSTRUCTION  
  
 20/11/23

**INNER WEST**

2-14 FISHER STREET, PETERSHAM NSW 2049  
 Ph. 02 9392 5000  
 Post: 20 Box 14, PETERSHAM  
 council@innerwest.nsw.gov.au  
 Web: https://www.innerwest.nsw.gov.au

SURV. GEN.	
R.M.S.	
A.G.L. / SHELL PIPELINES	
SYDNEY WATER	
TELSTRA / OPTUS	
AUSGRID	
NOTICE OF ENTRY	
KERB & GUTTER	
NOTICES	
DATE	

COORDINATE SYSTEM	ASSUMED		
SCALES (ORIGINAL A1)			
1:25			
REV.	DATE	DESCRIPTION	APPROV.

**WEST STREET, PETERSHAM**  
 AT THE BOULEVARDE  
 PROPOSED RAISED PEDESTRIAN CROSSING  
 CROSS SECTION DETAILS - ALIGNMENT LS2

PROJECT NO.	303082	SHEET NO.	11 of 18
PLAN NO.		10241	
SHEET REV #			

\\ns-002.innerwest.nsw.gov.au\wefc4\Asset and Environment\RTSR\CP\123\1191\303082-PE- WestSt@TheBoulevard-Release\MFC\10241-FMWP\DESIGN\12\_FinalDesign\100%Docs\303082-10241-Plans.dwg

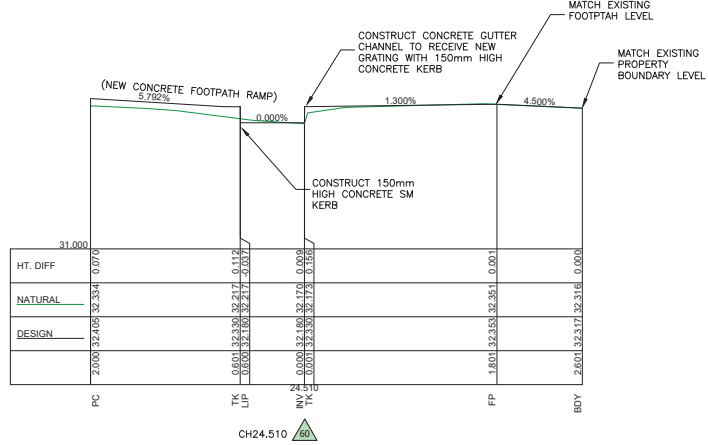
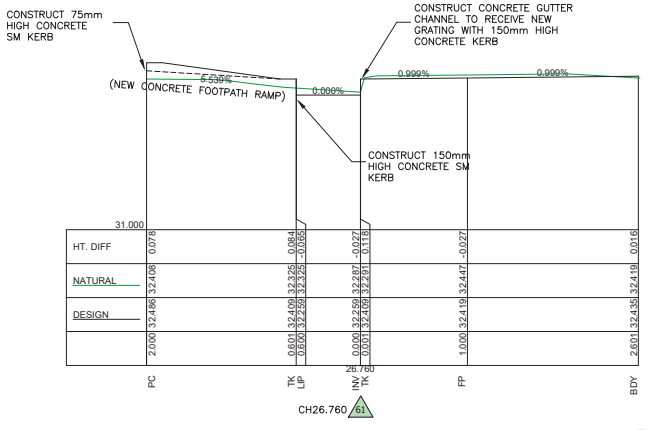
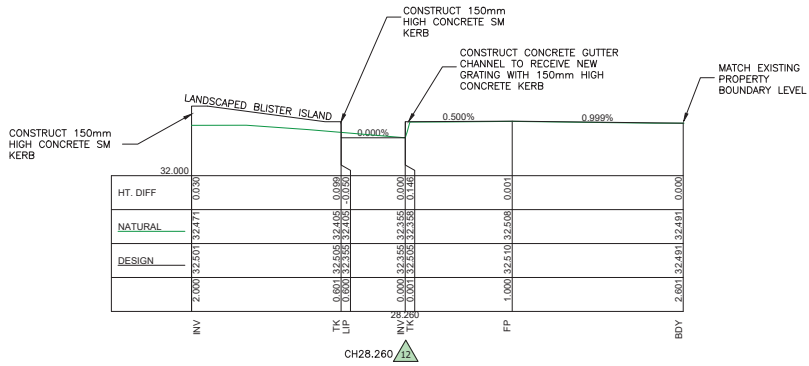

LEGEND	
BDY	- PROPERTY BOUNDARY
TK	- TOP OF KERB
INV	- GUTTER INVERT
LIP	- GUTTER LIP

LS2 CROSS SECTIONS FOR ALIGNMENT LS2 - IN FRONT OF PETERSHAM PUBLIC SCHOOL Scale: 1:25

FOR CONSTRUCTION

<p>CHECKED &amp; APPROVED</p> <p>20/17/23</p>	<p>SURVED BY ADAM DILLON 06-02-23</p> <p>DESIGNED BY JONATHAN WENG 28-06-23</p> <p>DRAWN BY JONATHAN WENG 28-06-23</p>		<p>SURV. GEN. R.M.S. A.G.L. / SHELL PIPELINES SYDNEY WATER TELSTRA / OPTUS AUSGRID</p> <p>NOTICE OF ENTRY KERB &amp; GUTTER NOTICES</p>	<p>COORDINATE SYSTEM ASSUMED</p> <p>SCALES (ORIGINAL A1) 1:25</p>	<p><b>WEST STREET, PETERSHAM</b> AT THE BOULEVARDE PROPOSED RAISED PEDESTRIAN CROSSING CROSS SECTION DETAILS - ALIGNMENT LS2</p>	<p>PROJECT NO. 303082</p> <p>SHEET NO. 12 of 18</p> <p>PLAN NO. 10241</p> <p>SHEET REV #</p>
<p>2-14 FISHER STREET, PETERSHAM NSW 2049 Ph. (02) 9392 5000 Post: PO Box 14, PETERSHAM council@innerwest.nsw.gov.au Web: https://www.innerwest.nsw.gov.au</p>			<p>REV. DATE DESCRIPTION APPROV.</p>			

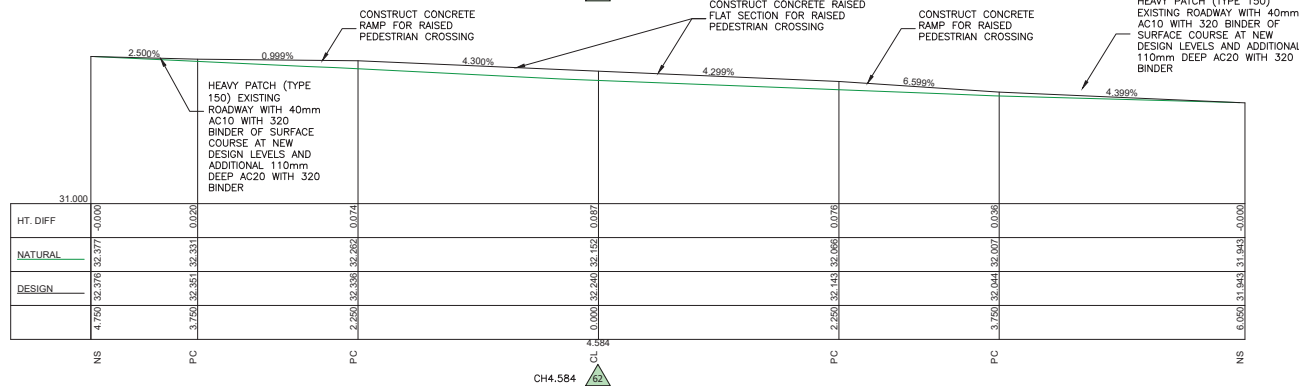
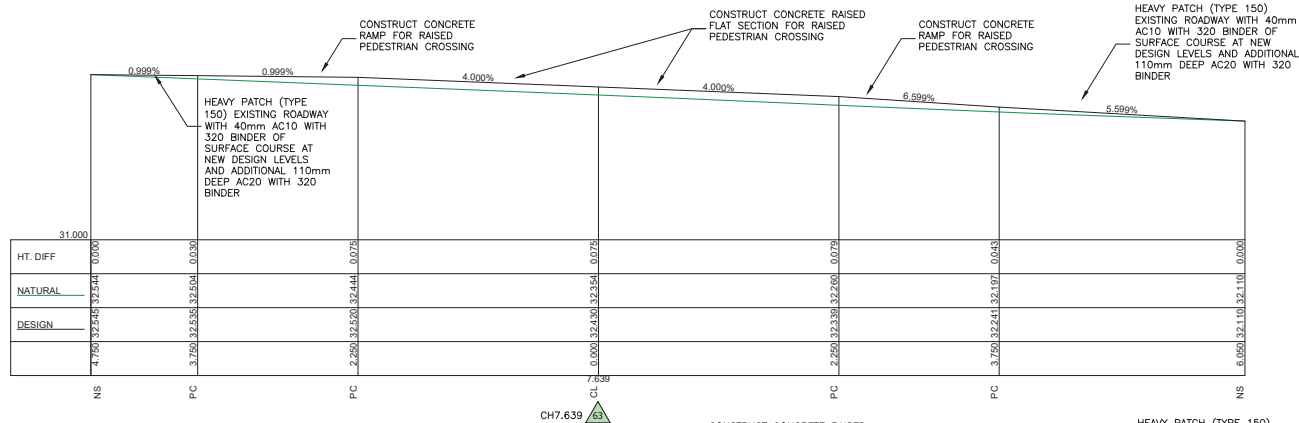
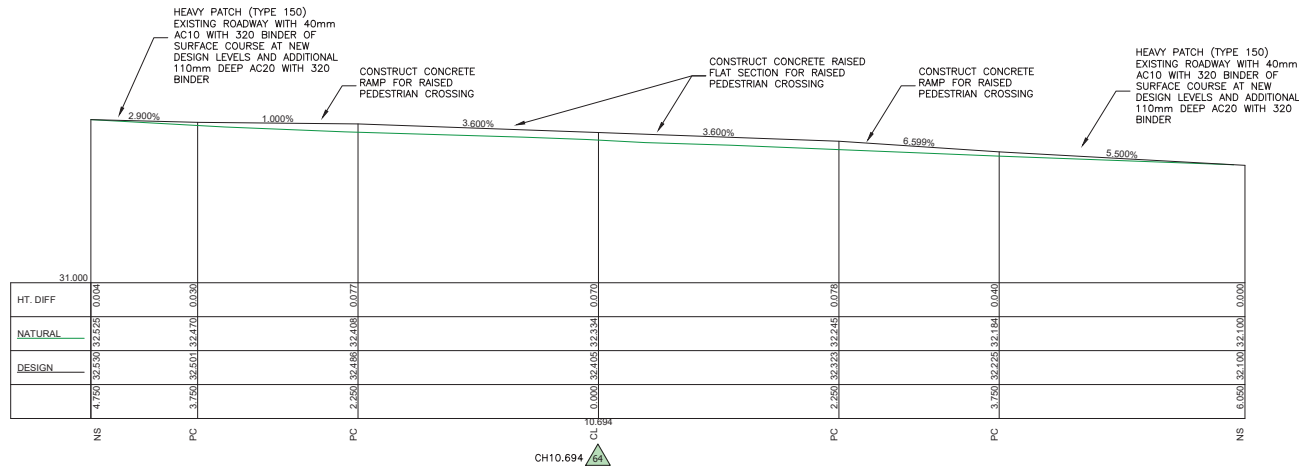

**LS3** CROSS SECTIONS FOR ALIGNMENT LS3 - ACROSS RAISED PEDESTRIAN CROSSING Scale: 1:25

LEGEND	
BDY	- PROPERTY BOUNDARY
TK	- TOP OF KERB
INV	- GUTTER INVERT
LIP	- GUTTER LIP

CHECKED & APPROVED  
  
 20/11/23

DESIGNED BY  
 JONATHAN WENG  
 28-06-23

APPROVED FOR CONSTRUCTION  
  
 20/11/23

**INNER WEST**

2-14 FISHER STREET, PETERSHAM NSW 2049  
 Ph: 02 9392 5000  
 Post: PO Box 14, PETERSHAM  
 council@innerwest.nsw.gov.au  
 Web: https://www.innerwest.nsw.gov.au

SURV. GEN.  
 R.M.S.  
 A.G.L. / SHELL PIPELINES  
 SYDNEY WATER  
 TELSTRA / OPTUS  
 AUSGRID  
 NOTICE OF ENTRY  
 KERB & GUTTER  
 NOTICES

COORDINATE SYSTEM  
 ASSUMED

SCALES (ORIGINAL A1)  
 1:25

REV.	DATE	DESCRIPTION	APPROV.

WEST STREET, PETERSHAM  
 AT THE BOULEVARDE  
 PROPOSED RAISED PEDESTRIAN CROSSING  
 CROSS SECTION DETAILS - ALIGNMENT LS3

PROJECT NO. 303082  
 SHEET NO. 13 of 18  
 PLAN NO. 10241  
 SHEET REV #

FOR CONSTRUCTION

\\p02\innerwest.nsw.gov.au\work\asset and Environment\KIB\CP\123\01\1917\303082-FC - West\16\16\theBoulevard-Raised\10241 - Plans.dwg | DESIGNED: 12/11/2017 | DRAWN: 20/11/2017 | CHECKED & APPROVED: 20/11/2017 | PROJECT NO. 303082 | SHEET NO. 14 of 18

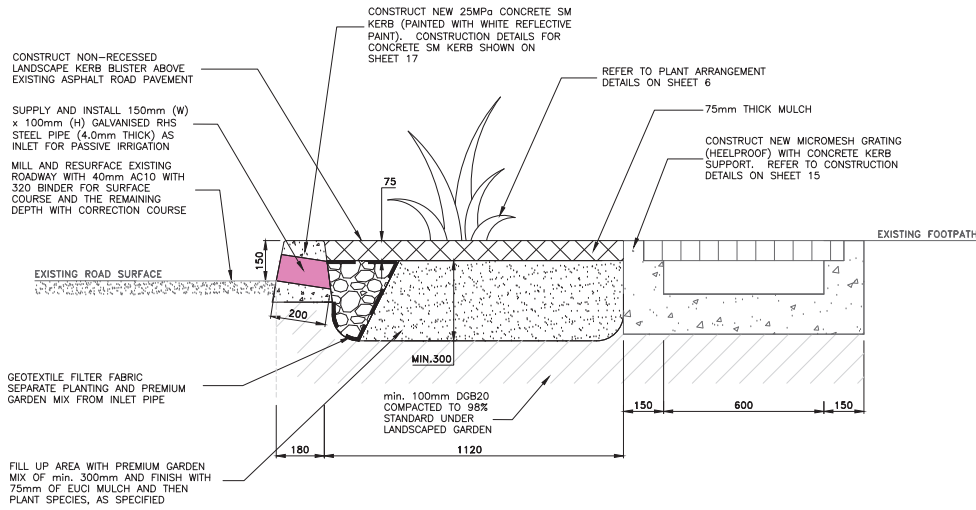

**TYPICAL CROSS SECTION B-B DETAIL - KERB BLISTER** B  
6  
SCALE 1:10

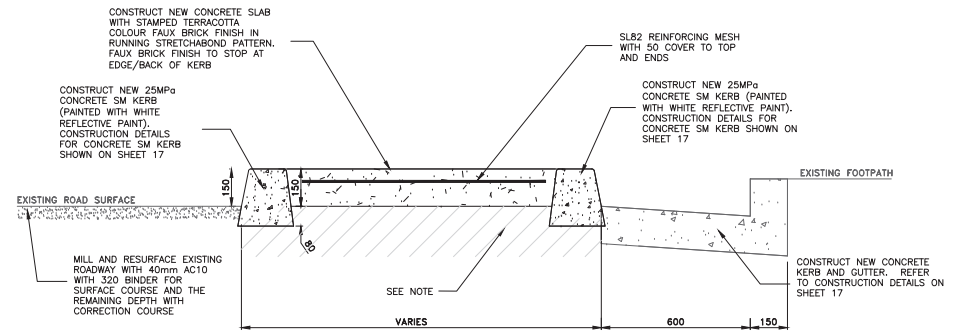

**TYPICAL CROSS SECTION D-D DETAIL - KERB BLISTER** D  
6  
SCALE 1:10

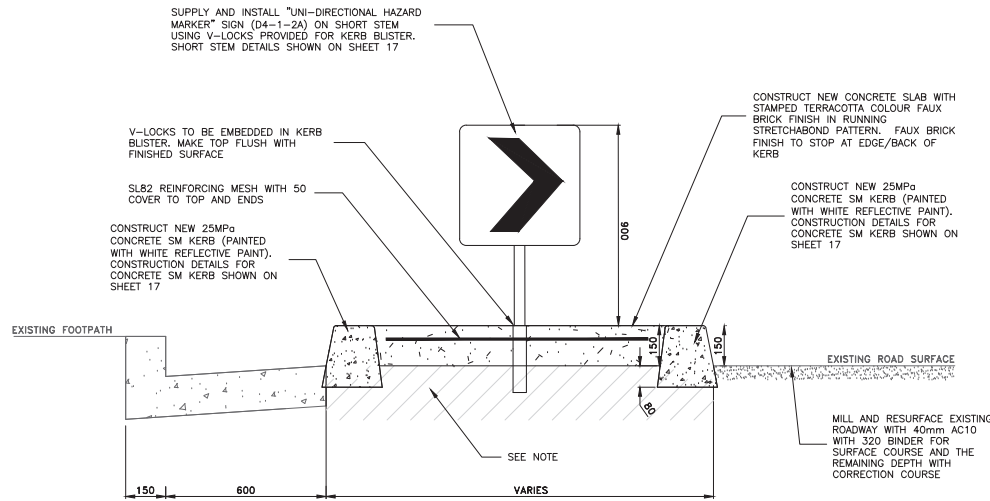

**TYPICAL CROSS SECTION A-A DETAIL - KERB BLISTER** A  
6  
SCALE 1:10

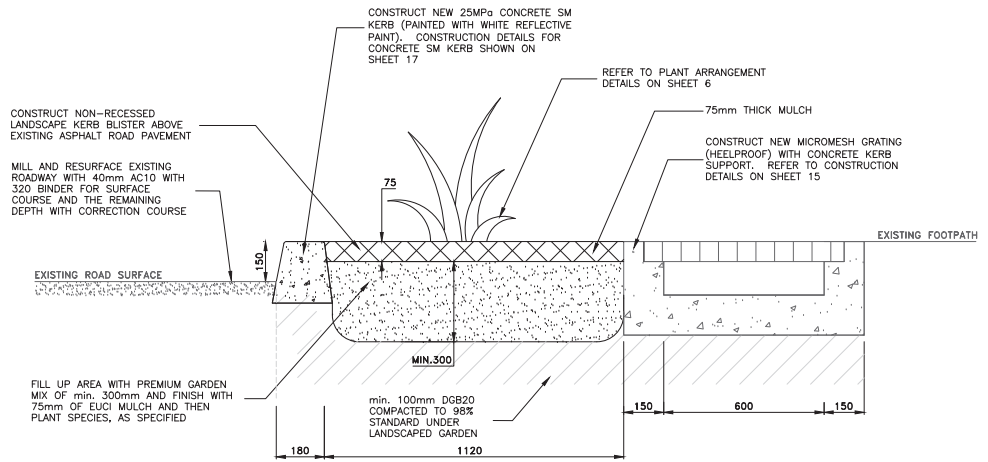

**TYPICAL CROSS SECTION C-C DETAIL - KERB BLISTER** C  
6  
SCALE 1:10

**NOTE:**  
 1) ROAD BASE SHALL BE PROVIDED BENEATH KERBS, GUTTERS, APRONS AND DISH CROSSINGS WITH 100mm THICK RECYCLED COMPACTED DGB20 OR 100mm THICK LEAN MIX CONCRETE.  
 2) COMPACTION: 95% STANDARD.  
 3) RECYCLED DGB SPECIFICATION: FOR SUPPLY OF RECYCLED MATERIAL FOR PAVEMENTS, EARTHWORKS, AND DRAINAGE. REFER TO "SPECIFICATION FOR SUPPLY OF RECYCLED MATERIAL FOR PAVEMENTS, EARTHWORKS AND DRAINAGE" BY IPWEA (NSW) (LATEST EDITION)

FOR CONSTRUCTION

CHECKED & APPROVED  20/11/23	SURVEYED BY ADAM DILLON 06-02-23	<h1 style="margin: 0;">INNER WEST</h1>	SURV. GEN. R.M.S. A.G.L. / SHELL PIPELINES SYDNEY WATER TELSTRA / OPTUS AUSGRID	COORDINATE SYSTEM ASSUMED SCALES (ORIGINAL A1) AS SHOWN	<h2 style="margin: 0;">WEST STREET, PETERSHAM</h2> <h3 style="margin: 0;">AT THE BOULEVARDE</h3> <h3 style="margin: 0;">PROPOSED RAISED PEDESTRIAN CROSSING</h3> <h3 style="margin: 0;">KERB BLISTER ISLAND DETAILS</h3>	PROJECT NO. 303082	SHEET NO. 14 of 18
APPROVED FOR CONSTRUCTION  20/11/23	DESIGNED BY JONATHAN WENG 28-06-23	2-14 FISHER STREET, PETERSHAM NSW 2049 Ph. 02 9392 5000 P.O. Box 14, PETERSHAM council@innerwest.nsw.gov.au Web: https://www.innerwest.nsw.gov.au	NOTICE OF ENTRY KERB & GUTTER NOTICES	REV. DATE DESCRIPTION APPROVED	PLAN NO. 10241	SHEET REV #	

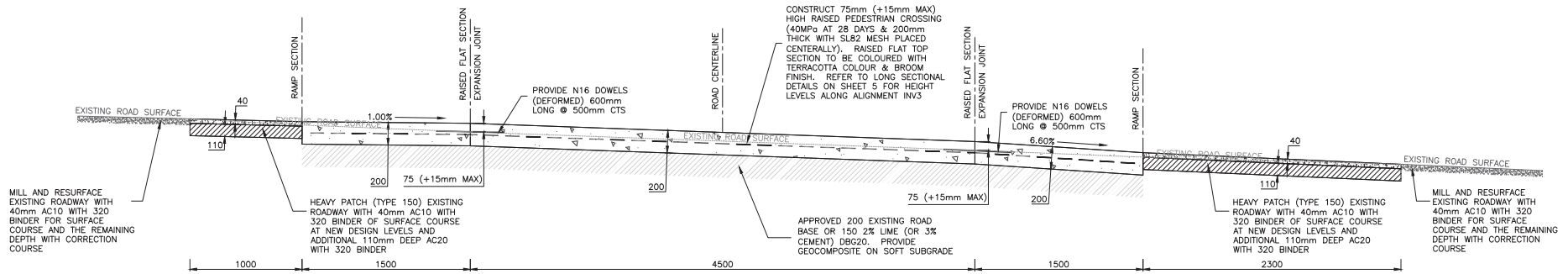

TYPICAL CROSS SECTION F-F DETAIL - RAISED PEDESTRIAN CROSSING (F7)  
SCALE 1:20

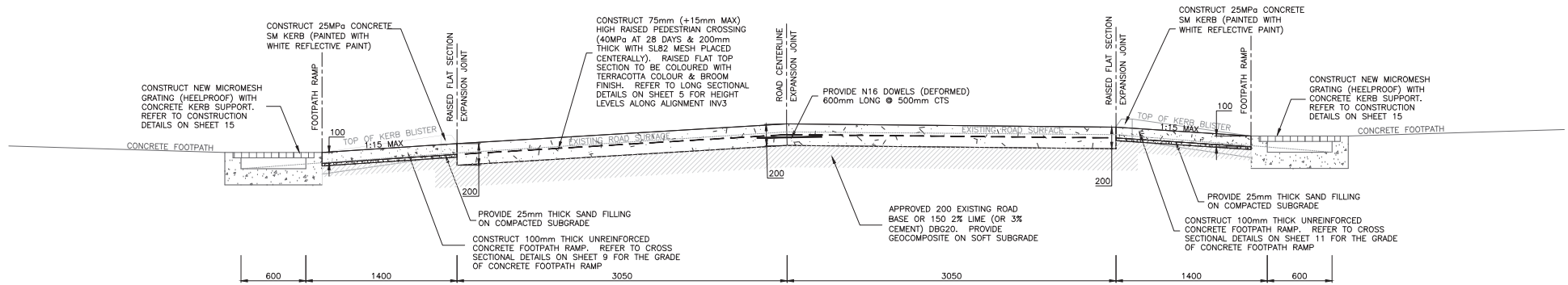

TYPICAL CROSS SECTION E-E DETAIL - RAISED PEDESTRIAN CROSSING (E7)  
SCALE 1:20

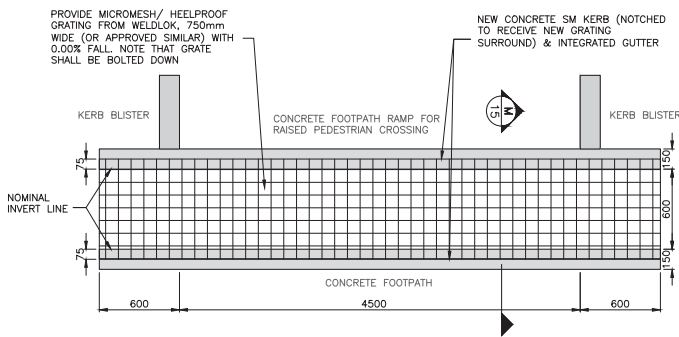

GUTTER BRIDGE (D1)  
SCALE 1:20

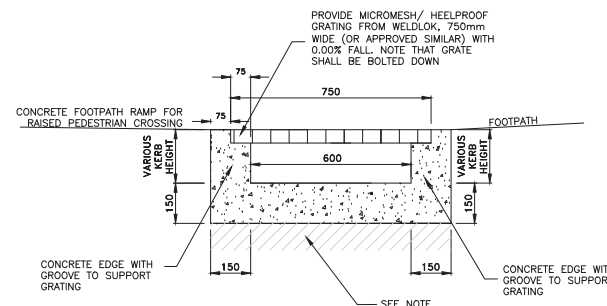

TYPICAL CROSS SECTION M-M DETAIL - MICROMESH GRATING WITH KERB SUPPORTS (M15)  
SCALE 1:10

- NOTE:
- ROAD BASE SHALL BE PROVIDED BENEATH KERBS, GUTTERS, APRONS AND DISH CROSSINGS WITH 100mm THICK RECYCLED COMPACTED DBG20 OR 100mm THICK LEAN MIX CONCRETE.
  - COMPACTION: 95% STANDARD.
  - RECYCLED DBG SPECIFICATION: FOR SUPPLY OF RECYCLED MATERIAL FOR PAVEMENTS, EARTHWORKS, AND DRAINAGE. REFER TO 'SPECIFICATION FOR SUPPLY OF RECYCLED MATERIAL FOR PAVEMENTS, EARTHWORKS AND DRAINAGE' BY IPWEA (NSW) (LATEST EDITION)

\\pww-002\innerwest-nsw.gov.au\projects\10241-Plans\10241-Plans.dwg - West Street Micromesh - Revised\DWG\10241-Plans.dwg - West Street Micromesh - Revised\DWG\10241-Plans.dwg

CHECKED & APPROVED	SURVEYED BY ADAM DILLON 06-02-23
DESIGNED BY JONATHAN WENG 28-06-23	DRAWN BY JONATHAN WENG 28-06-23



2-14 FISHER STREET, PETERSHAM NSW 2049  
Ph: 02 9392 5000  
PO Box 14 PETERSHAM  
council@innerwest.nsw.gov.au  
Web: https://www.innerwest.nsw.gov.au

SURV. GEN.	COORDINATE SYSTEM
R.M.S.	ASSUMED
A.G.L. / SHELL PIPELINES	SCALES (ORIGINAL A1)
SYDNEY WATER	AS SHOWN
TELSTRA / OPTUS	
AUSGRID	
NOTICE OF ENTRY	
KERB & GUTTER	
NOTICES	DATE

REV.	DATE	DESCRIPTION	APPROV.

**WEST STREET, PETERSHAM**  
AT THE BOULEVARDE  
PROPOSED RAISED PEDESTRIAN CROSSING  
RAISED PEDESTRIAN CROSSING DETAILS

PROJECT NO. 303082 SHEET NO. 15 of 18  
PLAN NO. 10241  
SHEET REF #

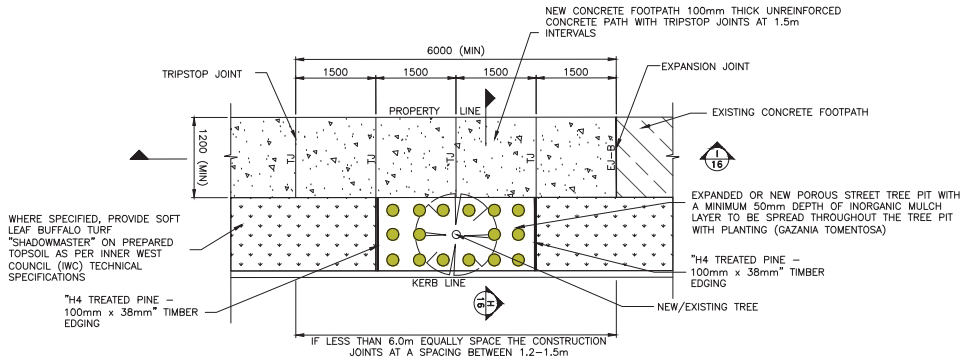

**UNREINFORCED CONCRETE FOOTPATH (F2) WITH TRIPSTOP JOINTS** D3  
SCALE 1:50

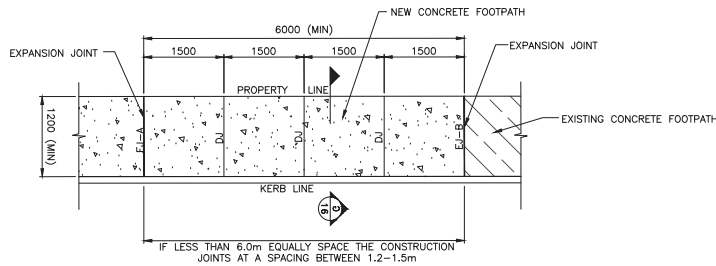

**UNREINFORCED CONCRETE FOOTPATH (F1)** D2  
SCALE 1:50

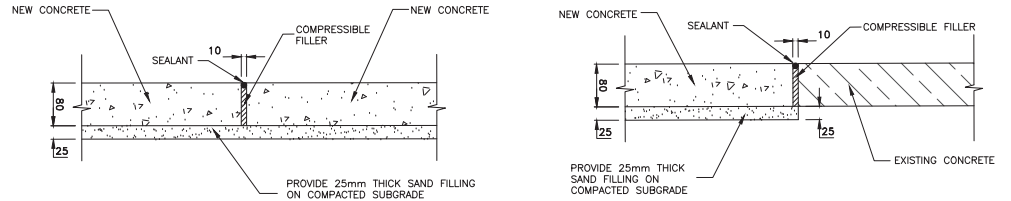

**CONCRETE FOOTPATH (F1) - EXPANSION JOINT A (EJ-A)** E1-A 16  
SCALE 1:5

**CONCRETE FOOTPATH (F1) - EXPANSION JOINT B (EJ-B)** E1-B 16  
SCALE 1:5

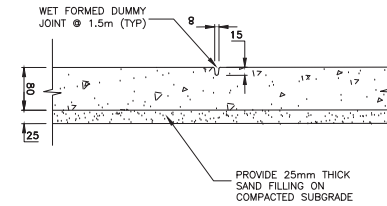

**CONCRETE FOOTPATH (F1) - DUMMY JOINT (DJ)** D1 16  
SCALE 1:5

- NOTES:**
- ROAD BASE SHALL BE PROVIDED BENEATH KERBS, GUTTERS, APRONS AND DISH CROSSINGS WITH 150mm THICK RECYCLED COMPACTED DGB20 OR 150mm THICK LEAN MIX CONCRETE.
  - COMPACTION: 95% STANDARD.
  - RECYCLED DGB SPECIFICATION: FOR SUPPLY OF RECYCLED MATERIAL FOR PAVEMENTS, EARTHWORKS, AND DRAINAGE. REFER TO 'SPECIFICATION FOR SUPPLY OF RECYCLED MATERIAL FOR PAVEMENTS, EARTHWORKS AND DRAINAGE' BY IPWEA (NSW) (LATEST EDITION)

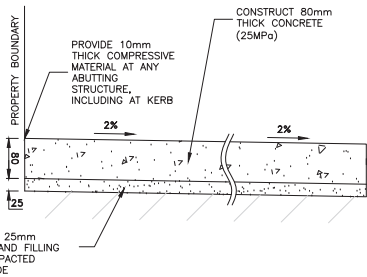

**CONCRETE FOOTPATH (F1) - SECTION G-G** G 16  
SCALE 1:5

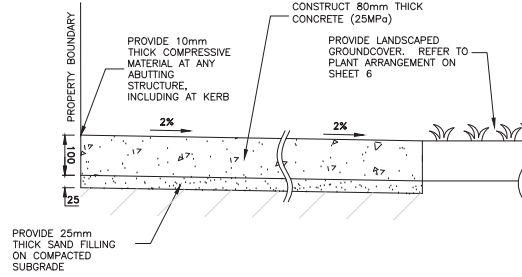

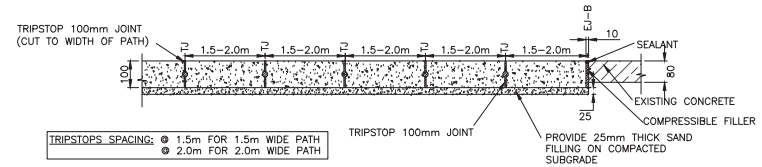

**CONCRETE FOOTPATH (F2) - SECTION H-H** H 16  
SCALE 1:5



**TRIPSTOP JOINT DETAILS FOR CONCRETE FOOTPATH (F2) - SECTION I-I** I 16  
NTS

FOR CONSTRUCTION

CHECKED & APPROVED  20/11/23	SURVEYED BY ADAM DILLON 06-02-23 DESIGNED BY JONATHAN WENG 28-06-23 DRAWN BY JONATHAN WENG 28-06-23	 2-14 FISHER STREET, PETERSHAM NSW 2049 Ph. 02 9392 5000 Post: PO Box 14 PETERSHAM council@innerwest.nsw.gov.au Web: https://www.innerwest.nsw.gov.au	SURV. GEN. R.M.S. A.G.L. / SHELL PIPELINES SYDNEY WATER TELSTRA / OPTUS AUSGRID NOTICE OF ENTRY KERB & GUTTER NOTICES	COORDINATE SYSTEM ASSUMED SCALES (ORIGINAL A1) AS SHOWN	PROJECT NO. 303082	SHEET NO. 16 of 18



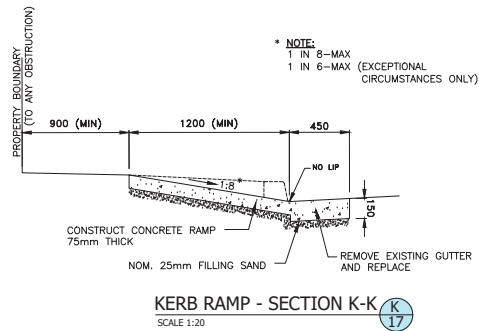
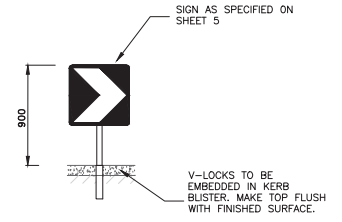
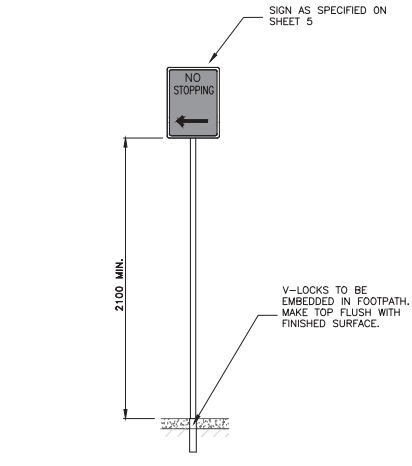
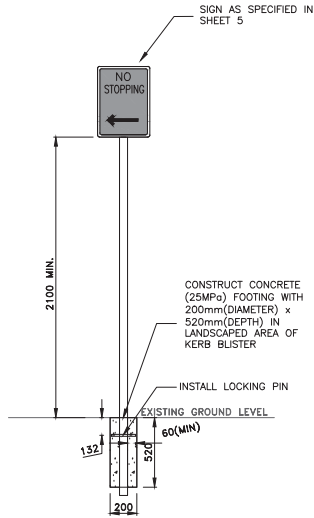
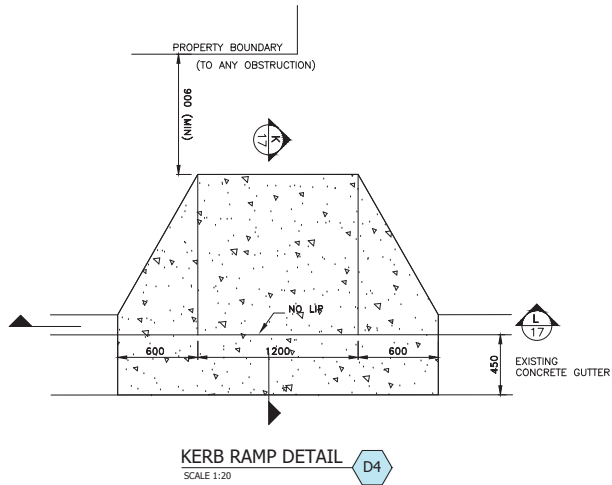

**SIGN STEM FIXING DETAIL - IN FOOTPATH (STANDARD STEM)** (D6)  
SCALE 1:20

**FIXING UNI-DIRECTIONAL HAZARD MARKER SIGN STEM DETAIL - IN KERB BLISTER (STANDARD SHORT STEM)** (D7)  
SCALE 1:20

**KERB RAMP - SECTION L-L (L17)** (L17)  
SCALE 1:20

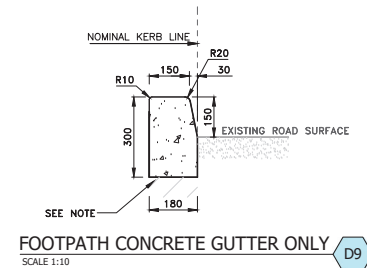
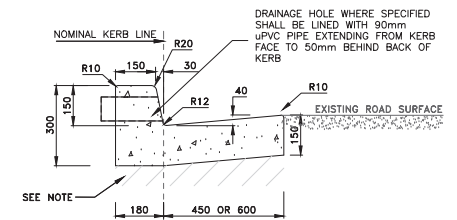
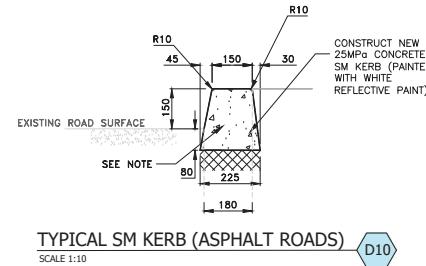
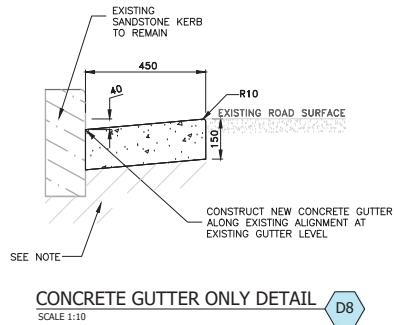
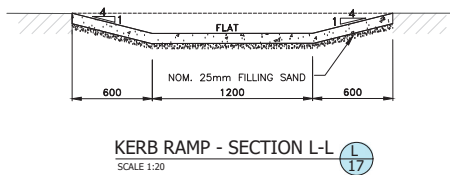

- NOTES:**
- ROAD BASE SHALL BE PROVIDED BENEATH KERBS, GUTTERS, APRONS AND DISH CROSSINGS WITH 150mm THICK RECYCLED COMPACTED DGB20 OR 150mm THICK LEAN MIX CONCRETE.
  - COMPACTION: 95% STANDARD.
  - RECYCLED DGB SPECIFICATION: FOR SUPPLY OF RECYCLED MATERIAL FOR PAVEMENTS, EARTHWORKS, AND DRAINAGE. REFER TO SPECIFICATION FOR SUPPLY OF RECYCLED MATERIAL FOR PAVEMENTS, EARTHWORKS AND DRAINAGE' BY IPWEA (NSW) (LATEST EDITION)

**FOR CONSTRUCTION**

CHECKED & APPROVED  20/11/23	SURVEYED BY ADAM DILLON 06-02-23  DESIGNED BY JONATHAN WENG 28-06-23  DRAWN BY JONATHAN WENG 28-06-23	<b>INNER WEST</b>  2-14 FISHER STREET, PETERSHAM NSW 2049 Ph. 02 9392 5000 Post: PO Box 14, PETERSHAM council@innerwest.nsw.gov.au Web: https://www.innerwest.nsw.gov.au	SURV. GEN. R.M.S. A.G.L. / SHELL PIPELINES SYDNEY WATER TELSTRA / OPTUS AUSGRID NOTICE OF ENTRY KERB & GUTTER NOTICES	COORDINATE SYSTEM ASSUMED  SCALES (ORIGINAL A1)  AS SHOWN	PROJECT NO. 303082  SHEET NO. 17 of 18  PLAN NO. 10241  SHEET REF #	WEST STREET, PETERSHAM AT THE BOULEVARDE PROPOSED RAISED PEDESTRIAN CROSSING CONCRETE KERB, GUTTER, KERB RAMP & SIGNS DETAILS

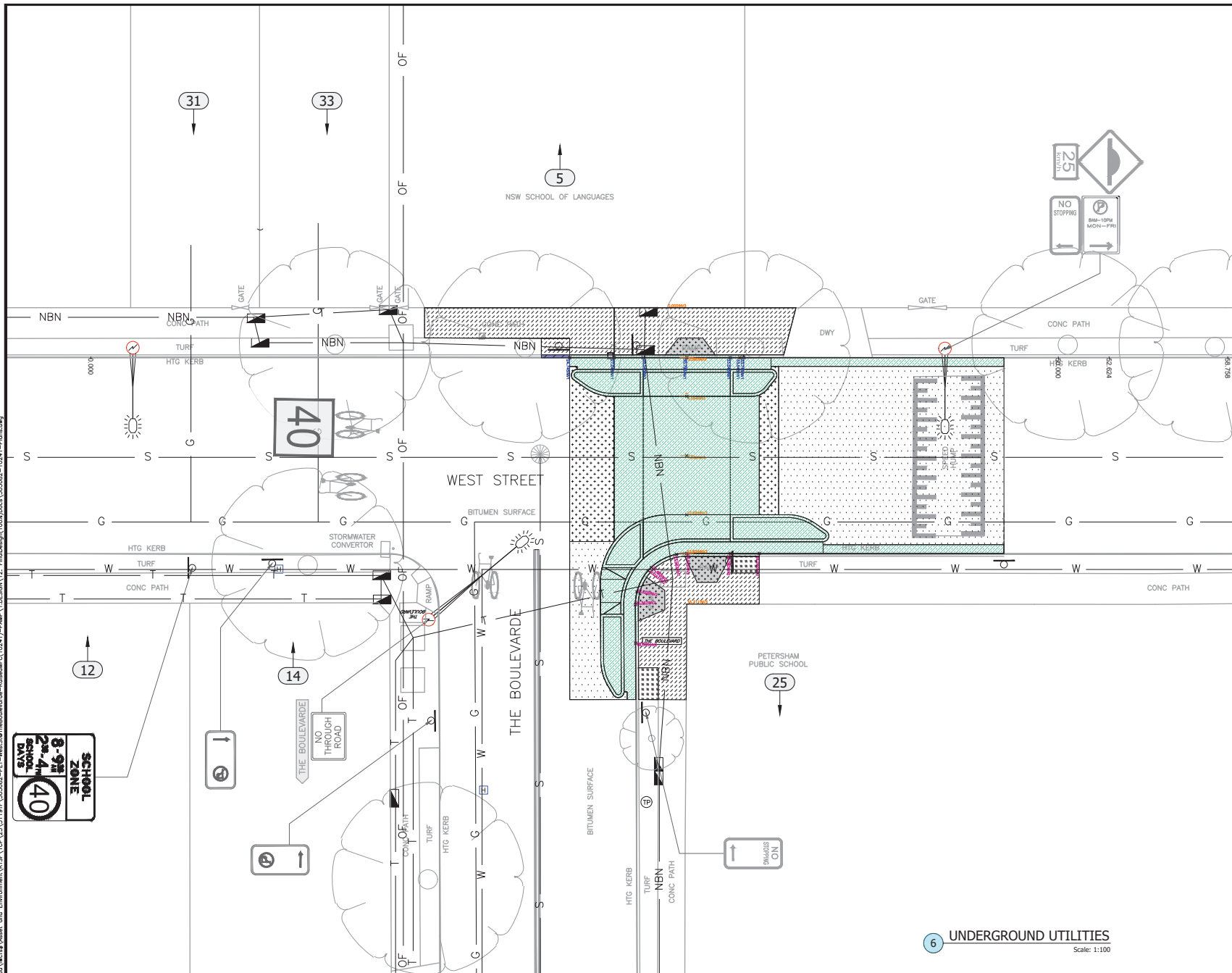

UTILITIES, IF SHOWN, ARE DIAGRAMMATIC ONLY. CONTRACTORS ARE RESPONSIBLE TO LOCATE AND AVOID DAMAGE TO THEM AS SPECIFIED BY EACH UTILITIES EXCAVATION GUIDELINES.

UTILITIES LEGEND

EXISTING SERVICES	
DRAINAGE LINE	-----
ELECTRICITY	----- E ----- E
GAS	----- G ----- G
OIL PIPELINE	----- P ----- P
SEWER	----- S ----- S
TELECOM	----- T ----- T
WATER SUPPLY	----- W ----- W
OPTIC FIBER	----- OF ----- OF
SUBSOIL	----- SS ----- SS
NBN	----- NBN ----- NBN
OPTUS	----- OPTUS ----- OPTUS
OVERHEAD ELECT.	----- E ----- E
O'HD ELECT & TEL	----- E T ----- E T
UNKNOWN	----- ? ----- ?

6 UNDERGROUND UTILITIES Scale: 1:100

FOR CONSTRUCTION

CHECKED & APPROVED  
  
 20/17/23  
 APPROVED FOR CONSTRUCTION  
  
 20/17/23

SURVEYED BY  
 ADAM DILLON  
 06-02-23  
 DESIGNED BY  
 JONATHAN WENG  
 28-06-23  
 DRAWN BY  
 JONATHAN WENG  
 28-06-23



2-14 FISHER STREET, PETERSHAM NSW 2049  
 Ph: (02) 9392 5000  
 Post: PO Box 14, PETERSHAM  
 council@innerwest.nsw.gov.au  
 Web: https://www.innerwest.nsw.gov.au



SURV. GEN.  
 R.M.S.  
 A.G.L. / SHELL PIPELINES  
 SYDNEY WATER  
 TELSTRA / OPTUS  
 AUSGRID  
 NOTICE OF ENTRY  
 KERR & GUTTER  
 NOTICES DATE

COORDINATE SYSTEM  
 ASSUMED  
 SCALES (ORIGINAL A1)  
 1:100

REV.	DATE	DESCRIPTION	APPROV.

WEST STREET, PETERSHAM  
 AT THE BOULEVARDE  
 PROPOSED RAISED PEDESTRIAN CROSSING  
 UNDERGROUND UTILITIES

PROJECT NO. 303082  
 SHEET NO. 18 of 18  
 PLAN NO. 10241  
 SHEET REV #